

Britax has received reports that the center tab can break in certain B-Safe infant car seats, potentially causing a choking hazard.

Before changing the chest clip, confirm that it needs to be replaced by following these steps.

1. Open chest clip. Press tab and pull the two sides of the chest clip apart (Fig. 1).
2. Turn chest clip over (Fig. 2).
3. If the back of your chest clip reads ABS, your chest clip must be replaced (Fig. 3). Follow the instructions attached for replacement.

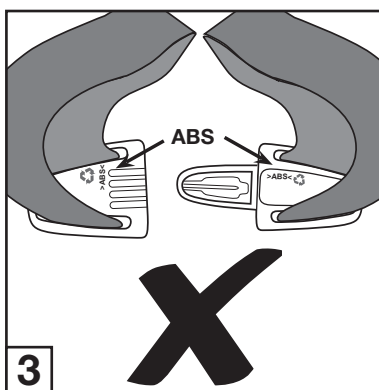
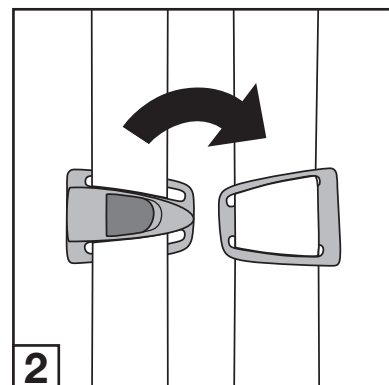
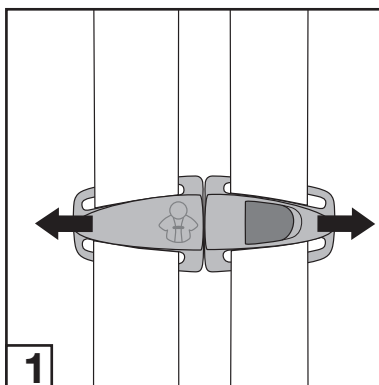

Chest Clip Kit:

- Chest Clip Assembly
- No Tools Required

Chest Clip Removal

1. Loosen the harness by pressing the harness adjuster release button and pulling both harness straps forward (Fig. 1).
2. From the back of the seat, remove the harness straps from the harness yoke (Fig. 2).
3. Carefully pull both harness straps to the front of the seat (Fig. 3).
4. Remove the comfort pads from each of the harness straps (Fig. 4) and set aside for later replacement.
5. Remove the chest clip from the harness straps and discard (Fig. 5).

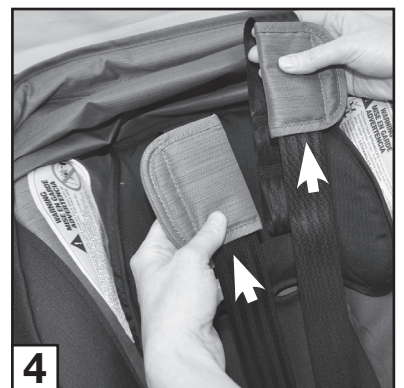
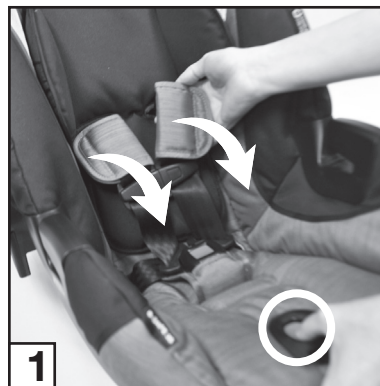

Chest Clip Removal

1. Route the harness straps through the new chest clip assembly.
2. Slide the comfort pads onto the harness straps.
3. Ensure that the harness straps are not twisted and route through the appropriate slots in the back of the seat (Fig. 6).
4. Secure the harness straps onto the harness yoke with the appropriate loops (Fig. 7 and 8).
 - Inner Loop: For infants weighing less than 11 lbs (5 kg).
 - Outer Loop: For infants weighing over 11 lbs (5 kg).
5. The installation is now complete and your infant car seat is ready to use.

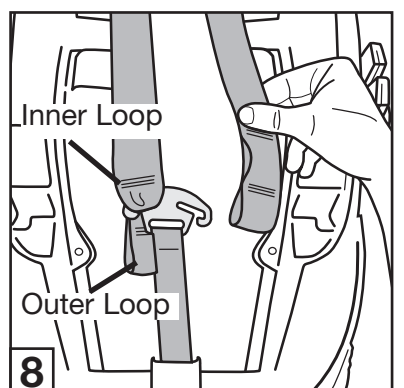
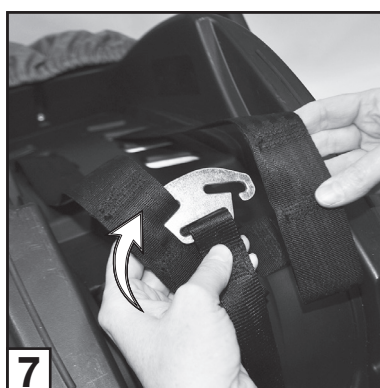

Video Instructions:

www.britax.co.nz/service-support/product-recalls/