

# britax safe·n·sound

## UNITY NEOS™

INFANT CARRIER

Birth to 12 months (approx.)

Instructions for Installation & Use

Series No. 40/B/2013

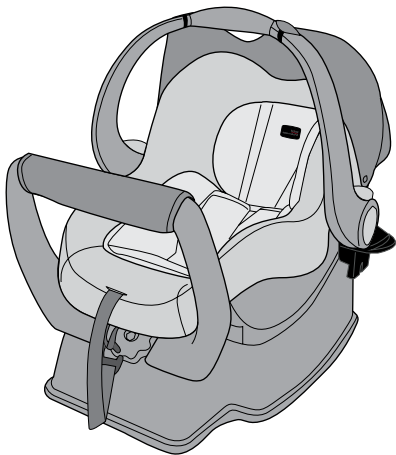

Birth to  
12 months  
(approx.)

NOTE: Style may vary from image shown.



**IMPORTANT: KEEP THIS BOOKLET IN THE PLACE  
PROVIDED ON THE CHILD RESTRAINT BASE**



## QUICK SETUP WITH SEATBELT

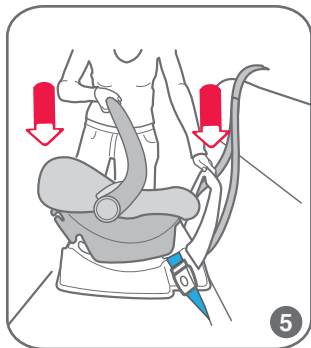
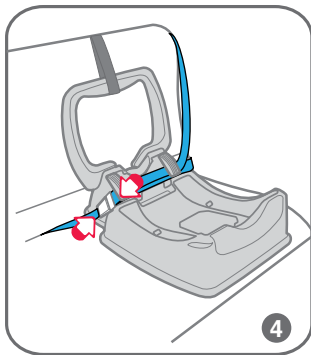
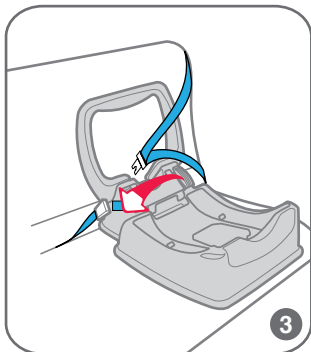
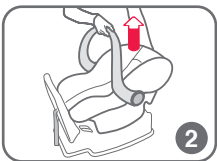
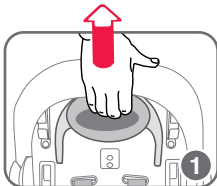

## QUICK SETUP WITH SEATBELT

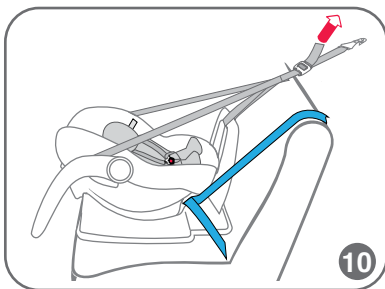
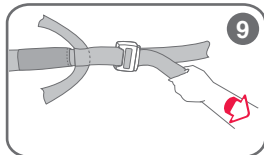
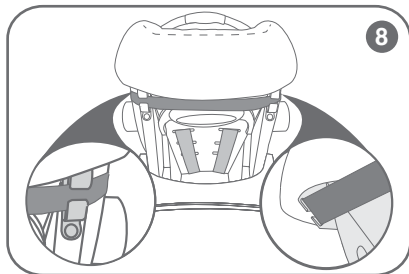
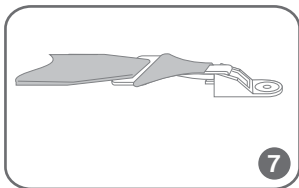
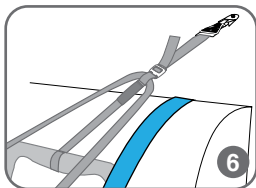



# INTRODUCTION

To be used only in a rearward-facing position until the infant's shoulders reach the shoulder height marker (approximately 12 months of age).

Continue to use this infant restraint until the child reaches this limit.

Infants are at risk of serious injury if they face forward too early.

إلى عيضرللا يفتك لصي ىتح فلخلإ إلى ةجاولم ةيعضولا يف طقف ةمادختسا متي  
(رهش 12 رمع يف أبيرقت) فاتكألا عافترا ةمالع  
دحل اذه إلى لفطل لوصو نيجل اذه عضرلا زجاج مادختسا يف رمتسا  
مألا إلى لههيجوت مت اذا ةريطخل لاتاباصلإ إلى ضرعتلل ةرطاخم يف عضرلا نوكي  
مزاللا نم رثكأ ةركبم ةروصب

只采用后向式安装，直到婴儿的肩膀达到肩高标记（大约12个月的宝宝）  
在儿童达到该座椅上限以前必须不断使用这一婴儿汽车座椅。  
婴儿过早乘坐前向式座椅则可能受到严重的伤害。

Να χρησιμοποιείται μόνο σε θέση στραμμένο προς τα πίσω μέχρι οι ώμοι του  
βρέφους να φτάσουν τον δείκτη ύψους του ώμου (περίπου 12 μηνών).  
Συνεχίστε να χρησιμοποιείτε αυτό το σύστημα συγκράτησης νηπίων μέχρι το παιδί  
να φτάσει σε αυτό το όριο.  
Τα νήπια κινδυνεύουν με σοβαρό τραυματισμό αν κοιτάζουν προς τα εμπρός πολύ  
νωρίς.

Magagamit lamang sa isang nakaharap sa likuran na posisyon hanggang sa  
maabot ng balikat ng sanggol ang marka ng taas ng balikat (humigit-kumulang 12  
na buwang edad).  
Ipagpatuloy ang paggamit ng pampigil ng sanggol na ito hanggang sa maabot ng  
bata ang limitasyong ito.  
Ang mga sanggol ay nasa seryosong peligro ng pagkapinsala kung sila ay haharap  
ng masyadong maaga.



## INTRODUCTION

---

Chỉ được sử dụng ở vị trí hướng mặt về phía sau cho đến khi vai em bé cao tới vạch ghi độ cao của vai (khoảng 12 tháng tuổi).  
Hãy tiếp tục sử dụng ghế em bé này cho đến khi em cao tới giới hạn này.  
Bé sơ sinh có nguy cơ bị chấn thương nghiêm trọng nếu hướng mặt về phía trước quá sớm.

केवल पीछे की तरफ मुँह किये हुये स्थिति में तब तक प्रयोग करें जबतक शिशु का कन्धा कन्धे के चनिह तक न पहुँच जाए (लगभग 12 महीने की आयु पर)।  
शिशु के इस सीमा तक पहुँचने तक इस शिशु प्रतबिन्ध का प्रयोग जारी रखें।  
शिशुओं को समय से पहले सामने की ओर बैठाए जाने पर उन्हें गम्भीर चोट का खतरा होता है।

Sólo debe utilizarse orientado hacia atrás hasta que los hombros del niño alcancen el marcador de altura (aproximadamente a los 12 meses de edad).  
Utilice este sistema de seguridad infantil hasta que el niño alcance ese límite.  
El niño corre el riesgo de sufrir lesiones graves si se utiliza la silla orientada hacia adelante antes de tiempo.

僅可後向安裝使用，直至嬰兒肩膀達到肩高標記（大約12個月大）。  
孩子應一直採用後向式坐姿，直至其達到後向式坐姿的上限。  
孩子若過早乘坐前向式汽車座椅，可能會對其造成嚴重的傷害。

Da utilizzare solo in posizione rivolta all'indietro fino a quando le spalle del bambino raggiungono il marcatore di altezza (circa 12 mesi di età).

Continuare a utilizzare questo sistema di ritenuta per neonati fino a quando il bambino raggiunge questo limite.

I neonati sono a rischio di lesioni gravi se messi in posizione frontale troppo presto.



# INTRODUCTION

---

The Infant Carrier and base is installed so that the infant is facing rearwards. This provides best position in a crash for infants.

No child restraint can guarantee absolute protection from injury in every crash. However, to ensure that your child gets all the protection designed into the restraint, PLEASE READ AND FOLLOW THESE INSTRUCTIONS EXACTLY and use only Safe-n-Sound recommended parts and accessories.

Carefully read all the instructions for installation in this book. If in doubt about the method of installation, consult Britax childcare or agent or a child restraint fitter or, in New Zealand, to consult the agent for the vehicle.

Regional Road Rules restrict the use of child restraints, like this Infant Carrier, in the front seat of the car. Check your local Road Rules.

Always store the instruction book in the place provided in the base when the Infant Carrier is removed.

The Infant Carrier is suitable for fitting to a variety of Britax, Steelcraft and BOB Strollers using one of the adaptor systems. For compatible Strollers refer to [www.britax.com.au](http://www.britax.com.au).

Britax Click & Go™ Adaptor is required for some strollers.

Britax Childcare Pty. Ltd. continues to provide care for your children when travelling in motor cars with a range of child restraints suitable throughout their childhood.



# INDEX

---

## PAGE

- 8** WARNINGS AND IMPORTANT MESSAGES
- 10** SHOULDER HEIGHT MARKERS AND A GROWING CHILD
- 12** SHOULDER HEIGHT MARKERS AND THE NEXT STEP
- 13** SPECIAL FEATURES
- 16** SUITABLE FOR USE
- 17** USING THE INFANT CARRIER
- 21** INSTALLING THE BASE
- 25** HOW TO INSTALL - TOP TETHER STRAP
- 27** INFANT CARRIER SETUP
- 32** HOW TO USE
- 39** HOW TO INSTALL IN AN AIRCRAFT
- 42** CARE & MAINTENANCE
- 47** ACCESSORIES
- 49** INSTALLATION OF CAR ANCHOR FITTING
- 54** ALTERNATIVE INSTALLATION IF SEATBELT LOOSENS
- 56** TRAVEL SYSTEM
- 57** TRAVEL SYSTEM - INTEGRAL LATCH
- 60** TRAVEL SYSTEM - BRITAX CLICK & GO™ ADAPTOR
- 65** TRAVELLING TIPS
- 66** IN CASE OF CRASH



## WARNINGS

- Use the restraint exactly as shown in the instructions.
- Supervision of children is needed because they may be able to undo the buckles and adjusters.
- **DO NOT LEAVE CHILDREN UNATTENDED IN THE CAR.**
- Do not alter or modify this restraint.
- Repairs must only be done by the manufacturers or agent.
- Fit the restraint firmly to the car seat.
- Fit the harness firmly to the child.
- A loose restraint or harness is dangerous.
- **DO NOT USE A REAR-FACING CHILD RESTRAINT WHERE AN AIRBAG IS FITTED IN FRONT OF THE SEATING POSITION.** For other airbags, refer to the car owner's handbook for warnings and instructions.
- To ensure infant's back is evenly supported do not put more than one nappy on the baby and make sure the nappy is not thickly folded at the back.
- Do not allow the restraint to come into contact with polishes, oils, bleach and other chemicals.
- Destroy the restraint if it has been in a severe crash, even if no damage is visible.
- Do not harness an infant wrapped in a blanket or swaddled. Any blanket or wrap must only be placed over the harness and infant.
- Always secure the loose end of the top tether strap. Do not use the child restraint where this strap may fall into the seat back or off the side of the seat.
- **ALWAYS ATTACH HOOK AND REMOVE SLACK.**
- **DO NOT USE THIS RESTRAINT WITHOUT THE COVER.**
- This infant carrier is only approved for use with the included base or an accessory base (additional purchase) of the same series number - 40/B/2013. It is not approved for use with a base that utilises ISOFIX compatible anchorages. Series injury may result from use of this infant carrier with a non-approved base.





## IMPORTANT :

- TO BE USED WITH A LAP-SASH OR LAP ONLY SEATBELT IN THE BACK OF MOST CARS WITH FORWARD FACING SEATS.
- Do not use the child restraint facing forwards. Do not use excessively upright or reclined.
- This restraint must be used in conjunction with a lap or lap-sash seat belt.
- Seatbelt extenders are not recommended to be used if the seatbelt is not long enough to secure the child restraint. If seatbelts are too short then seek advice from a child restraint fitter and consider their recommendations before using a seatbelt extender. If you use a seatbelt extender then ensure that the seatbelt buckle does not sit above the base moulding or prevent the carrier locking onto the base.
- THIS RESTRAINT IS NOT SUITABLE FOR USE WHERE THE TOP TETHER STRAP MAY FALL INTO A SPLIT IN THE SEAT BACK OR OFF THE SIDE OF THE SEAT.
- THIS RESTRAINT MUST BE ATTACHED TO A CHILD RESTRAINT UPPER ANCHORAGE POINT IN THE CAR. REFER TO CAR OWNER'S HANDBOOK FOR LOCATION OF UPPER ANCHORAGE POINTS. REFER TO A CHILD RESTRAINT FITTING STATION IF NO UPPER ANCHORAGE POINTS ARE IN THE MOTOR CAR.
- The restraint should not be purchased or sold as a second hand item. It is recommended not to use child restraints older than 10 years as the protection in an accident may be reduced.
- This child restraint is not approved for use with any connectors that connect to the car's ISOFIX low anchorages.
- Make sure the handle is latched properly every time you pick up the Infant Carrier.
- The restraint is not intended to be a substitute baby cot or bed. It is only designed to enable safe transportation of children in motor vehicles. Do not leave a baby in the restraint for long periods of time.



## SHOULDER HEIGHT MARKERS AND A GROWING CHILD

### NEW BABY

Shoulders below the Shoulder Height Marker.

Maximum Shoulder Height Marker.

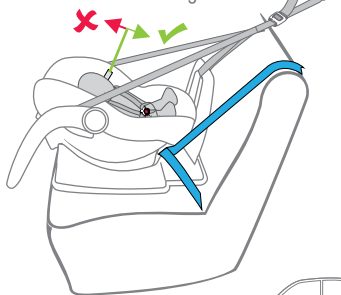

### OLDER BABY

Shoulders in-line with the Shoulder Height Marker- then you will need to move to the next child restraint.

Maximum Shoulder Height Marker.

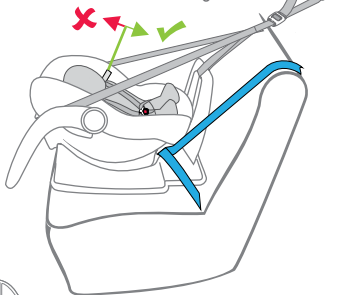

FRONT OF VEHICLE



The Infant Carrier is not suitable for your child when their shoulders are above the shoulder height marker.

If the baby's neck muscles are unable to support their head then the child should remain rear facing, choose a child restraint that will take larger babies in rear facing.

**DO NOT MOVE TO THE NEXT RESTRAINT UNTIL SHOULDERS REACH THE SHOULDER HEIGHT MARKER.**

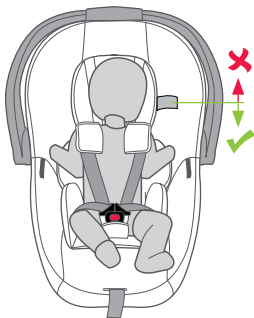



## SHOULDER HEIGHT MARKERS AND A GROWING CHILD

Shoulder height markers are provided on this restraint for a visual indication that the child is safe to ride in this restraint.

 **IMPORTANT: Follow this advice.**

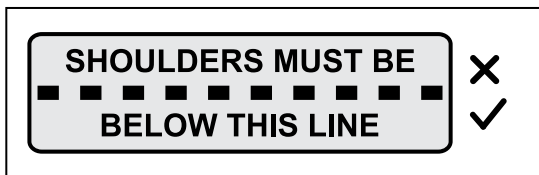

**DO NOT MOVE TO THE NEXT RESTRAINT UNTIL THE BABY'S SHOULDERS REACH THE SHOULDER HEIGHT MARKER.**

When the baby's shoulders reach this marker, the child is now too big for the Infant Carrier. It is now time to move to the next child restraint, see next page.

## SHOULDER HEIGHT MARKERS AND THE NEXT STEP

### Next type of restraint that can be used in the car for your child.

When your child has outgrown the seat, you can then either use:

- **Convertible Child Seat:** Suitable for approximately 12 months, continue to keep your child rear facing until the shoulders reach the lower shoulder height marker. Then turn to forward facing until the child reaches the upper shoulder height marker - approximately 4 years of age. Some convertible child seats may allow for the child to remain rearward facing until 2 to 3 years of age.



Convertible  
Child Seat

OR

- **Dedicated Forward Facing Seat with in-built harness:** Suitable for children who have outgrown their infant carrier (approximately 6 months old), up to approximately 4 years of age, or 8 years of age depending on the restraint.

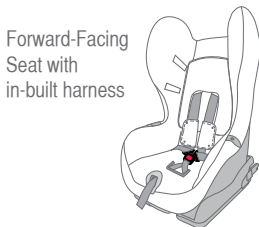

Forward-Facing  
Seat with  
in-built harness

OR

- **Convertible Booster Seat with in-built harness** that faces forward: Suitable for children who have outgrown their rear facing seat (approximately 6 months old). This seat can be used up to approximately 4 years of age with built-in harness and then be converted to a booster seat and used up to approximately 8 years of age.



Convertible  
Booster Seat

# SPECIAL FEATURES

## INFANT CARRIER

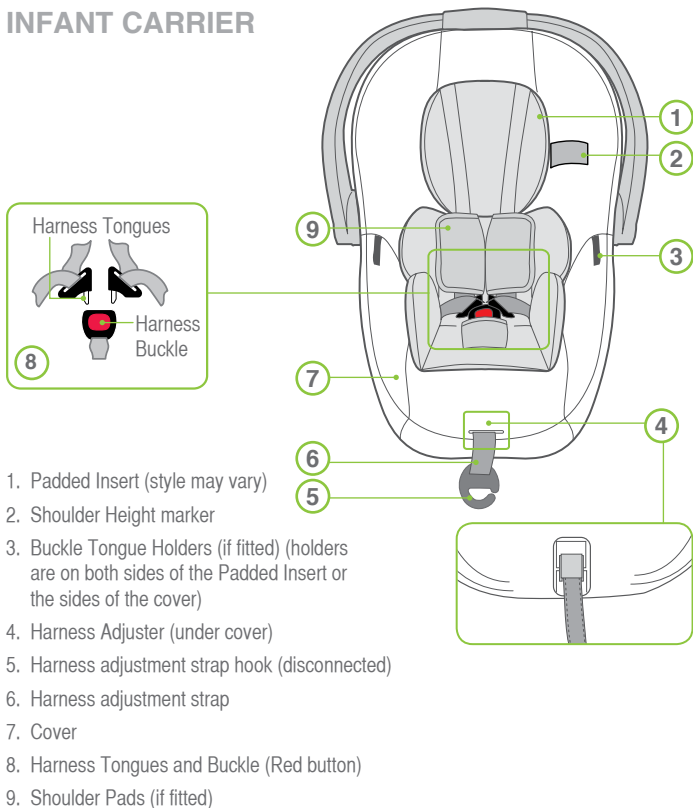

# SPECIAL FEATURES

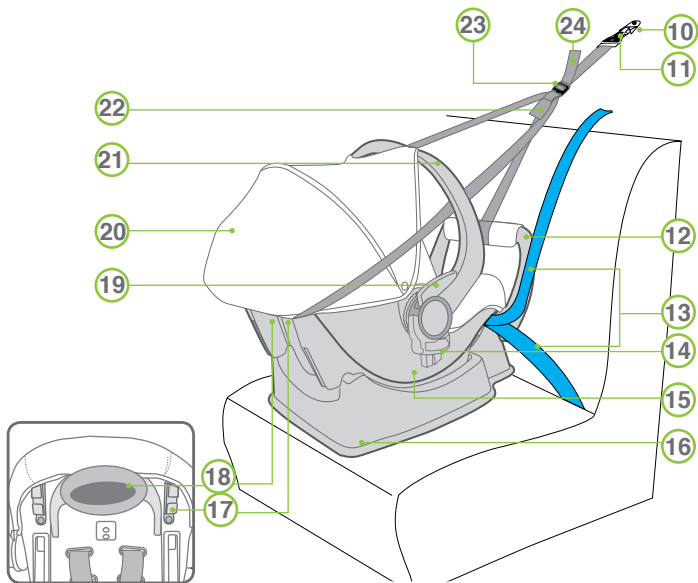

10. Car's Upper Anchorage fitting

11. Attachment Clip

12. Stabilising Bar

13. Car Seat belt

14. Britax Click & Go™ Adaptor

15. Infant Carrier

16. Base

17. Top Tether Strap guides

18. Infant Carrier Release Handle  
(Located at the back of the Infant Carrier)

19. Carry Handle release latch

20. Canopy

21. Carry Handle

22. Top Tether Storage Pocket

23. Top Tether Adjuster

24. Top Tether strap

# SPECIAL FEATURES

## BASE

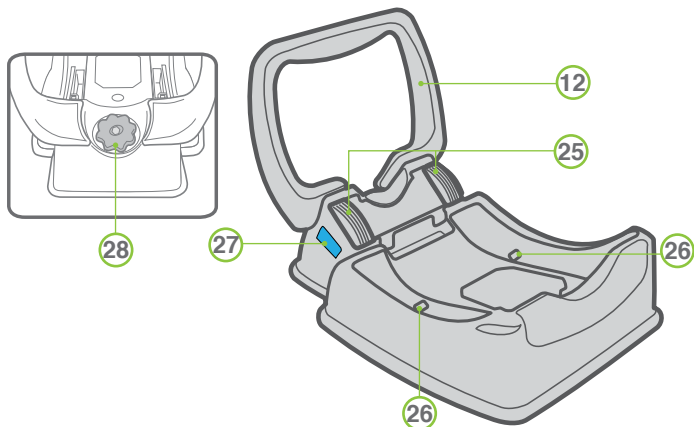

25. Belt Guide Hooks

26. Carrier Latching Points

27. Rearward-Facing Belt Path Label (shown in blue)

28. Levelling Knob

Top Tether not shown for illustration purposes.

## SUITABLE FOR USE

If the baby's neck muscles are unable to support their head, then the child should remain rear-facing, choose a restraint that will suit larger babies in a rear-facing mode.



To ensure that the space is sufficient, the purchaser should check the measurements between the vehicle's rear and front seats in which the child restraint is intended to be used. Ensure babies and toddlers are adequately shaded from direct sunlight through side or rear windows.

Check the car is ventilated by opening windows or using the car's ventilation system taking in external air. Recirculation setting is not suitable for providing ventilation.



### WARNING

**THE TETHER STRAP MUST ALWAYS BE FITTED WHEN THE CHILD RESTRAINT IS USED IN A VEHICLE.**

Do not use the restraint without the top tether strap correctly attached.

The top tether strap must be attached to an anchorage point using an extension strap if necessary.

The Infant Carrier may just touch the front seat, but must not in such a way that the installation angle is affected.

Do not allow the front seat to alter the installed position of the restraint, It is permissible to allow the restraint to touch the seat in front of it.

Do not recline the seat excessively, it must be installed at the correct angle (see page 21 - 22).

Do not use on any vehicle seat which faces sideways or rearwards.





# USING THE INFANT CARRIER

## REMOVING INFANT CARRIER FROM BASE

A. Grasp the handle with one hand. With the other hand, lift the catch located at the front of the Infant Carrier.

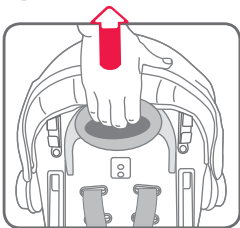

B. With the catch still lifted raise the Infant Carrier clear of the base.

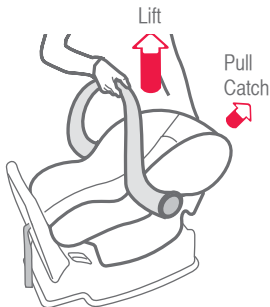



# USING THE INFANT CARRIER

## ADJUSTMENT OF HANDLE POSITION WITH BRITAX CLICK & GO™ ADAPTOR

- A. Squeeze the carry handle release latches on both sides of the handle and rotate handle to the first position - "rocking position" **2**.
- B. Squeeze the latch again and start to rotate the handle then remove both hands from the latches and use one hand at the top of the handle to rotate down further until the handle latches in the second or "non-rocking position" **3**. The carrier is now locked to the stroller.

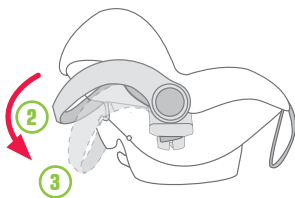
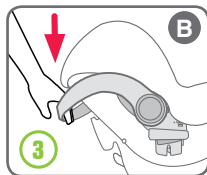
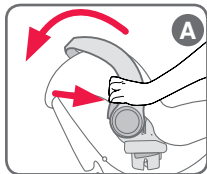

Push down until it clicks into place.



To avoid pinching your fingers follow the steps above.

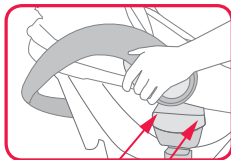

# USING THE INFANT CARRIER

## ADJUSTMENT OF HANDLE POSITION

The Infant Carrier features a sturdy carry handle which can be used in conjunction with the curved base to convert it to a rocker. At the base of the handle there are two large buttons which control the three positions of the handle. These positions are the "carry (or travel) position" ①, the "rocking position" ②, and the "non-rocking position" ③.

- A. To convert from carry to "rocking position" ②, depress the large buttons on each side and rotate the handle towards the front of the Infant Carrier. When you have started rotating the handle release the buttons and continue rotating the handle round until it locks into position.
- B. Ensure the handle is locked in position securely. The "rocking position" ② enables the Infant Carrier to rock without the possibility of the Infant Carrier tipping over.
- C. To convert to a "non-rocking" ③ position depress both buttons and rotate the handle to the fixed position. Ensure the handle is locked in position securely.

### ① Carry Position



### ② Rocking Position



### ③ Non-rocking Position



### IMPORTANT :

Do not place the Infant Carrier on a table or a work-top where it could fall off.

# USING THE INFANT CARRIER

## TO FIT AND USE THE CANOPY

- A. Fit Canopy over infant carrier with elastic at the end.
- B. Loop elastic around carry handle and clip in press studs. Check the elastic around the back of the carrier has not lifted.
- D. The Canopy can be rotated to cover the baby or folded by rotating to the desired position using the carry handle.

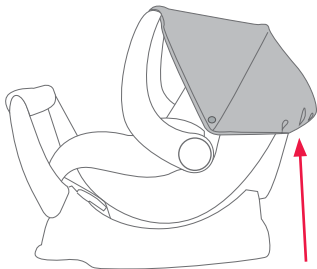

Elastic around infant carrier

## TO REMOVE CANOPY

- A. Unclip the press studs from carry handle and remove canopy.

Unclip press studs on carry handle to remove canopy

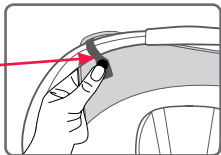

# INSTALLING THE BASE

## INSTALL INTO VEHICLE

Remove all packaging from the Infant Carrier.

Consult the car owner's handbook for location of top tether anchorage points.

If there is no child restraint anchor fitting or child restraint anchor point refer to pages 49 to 53 for the installation of the anchor fitting as well as the use of extension straps.

An anchor fitting is required to attach the top tether strap to fully install the Carrier to the car. The top tether strap must be used with this infant carrier when used in the car.

For installing the Base to the car, select a seating position with a child restraint anchor fitting directly behind the seating position.

## ADJUSTING THE BASE ANGLE

- A. Place the base and Infant Carrier on vehicle seat in a seating position where a child restraint anchor fitting is installed. The Level Indicator Line should be level with the road, (i.e. parallel with the road surface). Check and adjust the Levelling knob of the base if necessary.

- B. If your car's seat is contoured then you may need to adjust the angle of the base so your baby is not too upright.

The angle may be altered by turning the base levelling knob located at the rebound bar end which will cause the levelling foot to extend from the underside of the base.

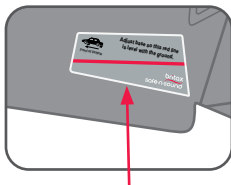

Level Indicator Line on both sides of base.

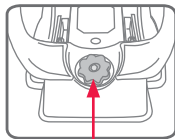

Levelling Knob



# INSTALLING THE BASE

Always leave a rearward slope angle of approximately 10° to 15°

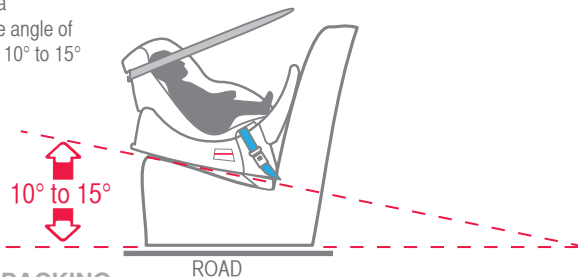

## MANUAL PACKING

The angle may also be altered by placing a firm packing between the seat and the underside of the base (packing can be a firmly rolled up towel)

For some vehicles with flat seats, packing may be required at the front edge of the base to get some recline. The stabilising bar does not need to touch the car's seat back but should be close.

Always leave a rearward slope angle of approximately 10° to 15°

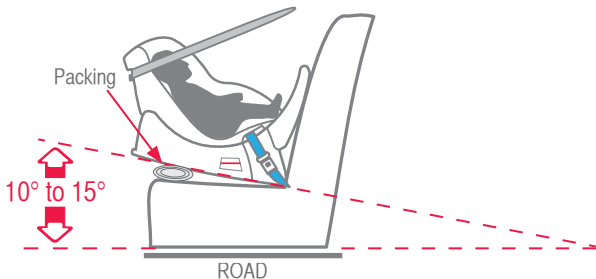

# HOW TO INSTALL THE BASE

## HOW TO INSTALL BASE USING LAP SASH SEATBELT

- A. Place the base into the car in the selected seating position with the Stabilising bar against the vehicle seatback as shown. Confirm the base angle as desired, otherwise adjust as shown on page 25 to 26.

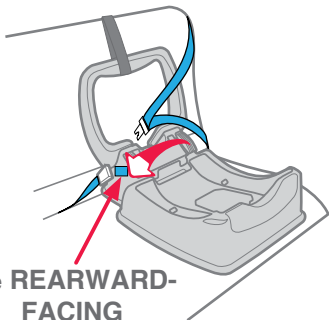

Blue **REARWARD-FACING BELT PATH** label

- B. Extend the seat belt to maximum length. For a lap-sash seat belt, position the tongue in the middle of the fully extended belt. Feed the seatbelt through the blue REAR-FACING SEATBELT PATH labels on each side and under Belt Guide Hooks.

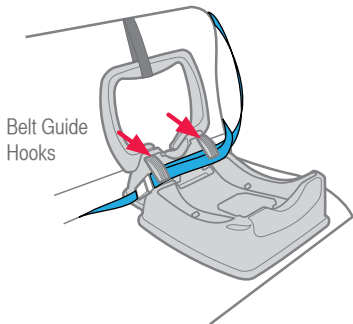

Belt Guide Hooks

# HOW TO INSTALL THE BASE

- C. Engage the seat belt tongue to the buckle. Push downwards and rearward on the restraint base to compress it into the vehicle seat. Whilst compressed in the seat, pull on the lap belt to remove slack.
- D. If a lap-sash seat belt is used then allow the excess sash belt to feed back in to the retractor.

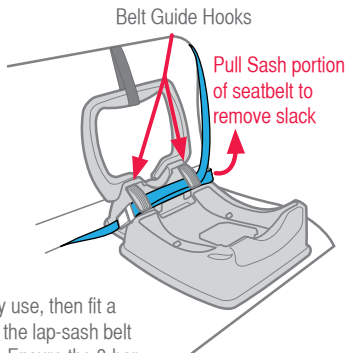

If the seat belt will not stay tight in every day use, then fit a gated 3-bar slide (not supplied with seat) to the lap-sash belt to prevent loosening. See pages 54 and 55. Ensure the 3-bar slide is removed when the Infant carrier base is not installed to allow other uses to use the seatbelt as a lap-sash seatbelt.

- E. Locate the child restraint upper anchorage fitting in the vehicle that is directly behind the rear seat location chosen. Refer to the car owner's manual for the location (If there is no upper anchorage fitting then refer to pages 49 to 53 for instructions in adding an anchor fitting).

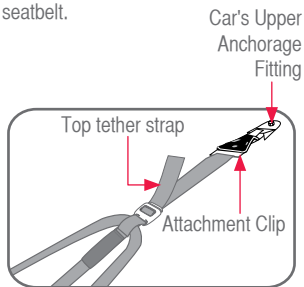

- F. Connect the top tether strap attachment clip to the anchor fitting in the car as detailed on page 25. Install top tether strap to the Infant Carrier as shown on page 25.



# HOW TO INSTALL - TOP TETHER STRAP

Once the carrier is fitted to the base, refer to page 32.

- A. Lengthen the strap fully by pressing the adjuster button (1) and pull the strap (2) so that the strap is ready to attach to the Carrier.

**THIS TOP TETHER STRAP MUST ALWAYS BE FITTED WHEN THE INFANT CARRIER IS USED IN THE CAR.**

- B. Feed the Top tether strap through the inside of the handle, around the front of the carrier and through the Top Tether Strap guides in the front of the Infant Carrier.

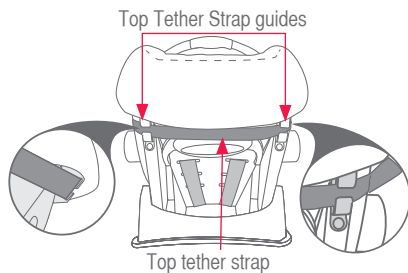

- C. Adjust the top tether strap by pulling (3) as shown in Fig. 1 to remove all slack in the straps. Do not over tighten.
- D. Roll up excess strap and place into the storage pocket attached to the top tether.

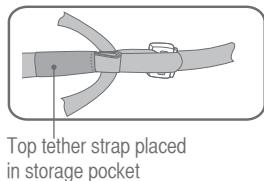
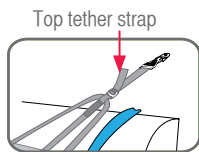
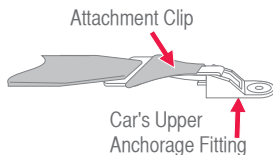
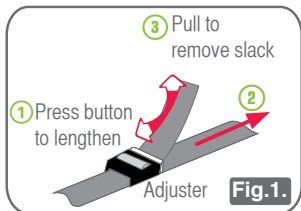

## HOW TO INSTALL - TOP TETHER STRAP



### **IMPORTANT :**

The Top tether strap must be fitted at all times when the baby is in the car.

Always secure the loose end of the top tether strap to prevent it hanging out of the car or being accessible by the child.

THIS RESTRAINT IS NOT SUITABLE FOR USE WHERE THE TOP TETHER STRAP MAY FALL INTO A SPLIT IN THE SEAT BACK OR OFF THE SIDE OF THE SEAT.

**ALWAYS ATTACH TOP TETHER HOOK AND REMOVE SLACK IN THE TOP TETHER STRAP.**



### **CAUTION:**

**CHILDREN CAN BE INJURED OR RESTRAINTS AND TOP TETHER STRAP DAMAGED BY UNSECURED CARGO IN A COLLISION. SECURE OR REMOVE HAZARDOUS CARGO BEFORE USING THIS CHILD RESTRAINT.**

## REMOVING THE BASE FROM THE CAR

When removing the base, release the attachment clip from the car's upper anchor fitting then remove the vehicle seatbelt.

# INFANT CARRIER SETUP

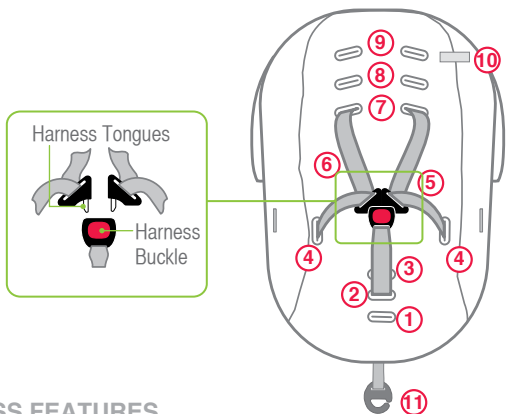

## HARNESS FEATURES

1. Outer crotch strap slot
2. Middle crotch strap slot
3. Inner crotch strap slot
4. Lap strap slot
5. Harness tongues & buckle
6. Shoulder harness strap
7. Lower shoulder strap slots
8. Middle shoulder strap slots
9. Upper shoulder strap slots
10. Maximum shoulder height marker.
11. Harness Adjuster (under cover flap)

# INFANT CARRIER SETUP

## CROTCH STRAP

The Infant Carrier is fitted with three crotch strap positions. Correct location of crotch strap will assist to correctly and securely position the infant and will help prevent the infant from slipping further down the Infant Carrier or slumping.

NOTE: The inner crotch strap slot location is shorter than other positions. This can be used to position the buckle lower on the baby.

As baby grows the crotch strap must be moved towards the outer slot.

## ADJUSTMENT OF CROTCH STRAP

Remove infant from the infant carrier prior to making adjustments.

- Remove the Infant Carrier from base as instructed on page 17.
- Lift Infant Carrier cover to reveal crotch strap slot.
- From the top side of Infant Carrier turn the crotch 3-bar slide and push it through each slot as shown right until the Crotch strap assembly is free from the Infant Carrier.
- Locate desired slot in shell, cover and padded insert (if fitted)
- Insert Crotch strap through desired slot and feed back through other slot as shown right.
- Ensure crotch strap is not twisted and positions the red button outwards.

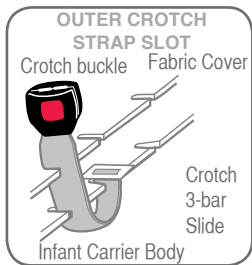
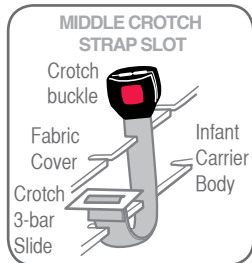
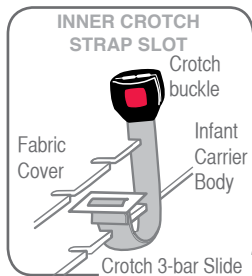
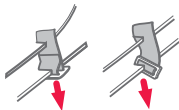

# INFANT CARRIER SETUP

## ADJUSTING THE SHOULDER STRAPS

Remove infant from the infant carrier prior to making adjustments.

- A. At the rear of the Infant Carrier, remove one of the harness shoulder straps from metal strap connector by slipping strap through open slot. The metal strap connector is shown in diagram right.
  - B. Pull the shoulder strap through slot to the front of the Infant Carrier, through all the trims.
  - C. Pass shoulder strap back through desired slot in padded insert cover and corresponding slot in the shell. The slot MUST position the shoulder strap level with or the next slot above the baby's shoulder.  
If a Padded Insert is used, that will need to be re-positioned and the strap re-inserted when changing the slot position.
  - D. Refit the shoulder strap to the metal strap connector.
- Repeat straps A,B and C for the other strap.

Ensure both shoulder straps use the same height slot pairs.

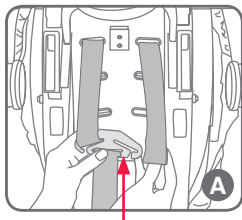

Metal Strap Connector

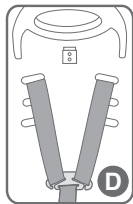
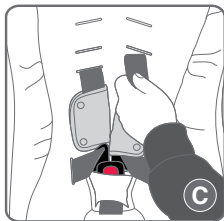

### IMPORTANT :

When replacing straps, cover and padded insert, ensure none of the straps are twisted and that all straps are secure by pulling each harness strap.

# INFANT CARRIER SETUP

## SETTING UP THE HARNESS

This section covers the setting up of the harness to fit the infant. Fitting the harness is not required. Securing of the infant is covered later in the instructions.

The Infant Carrier is fitted with three shoulder strap positions. As the baby grows the shoulder straps must be moved to higher slots.

- A. Sit the Infant Carrier on flat ground with the handle rotated fully back to prevent rocking.
- B. Lengthen the harness straps by pressing the harness adjuster (under the flap) and pulling both shoulder harness straps evenly. Release the buckle.
- C. Move the two harness tongues to the sides of the infant carrier and store in the buckle tongue holder (if fitted) (holders are on both sides of the padded insert or the sides of the cover). Move the harness buckle towards the harness adjuster.
- D. Place baby into infant carrier lying on its back so that the buckle is between the legs.
- E. Determine which Infant Carrier straps require adjustment to fit the harness correctly:

Confirm crotch strap position required, followed by shoulder straps position. Adjust as required following the instructions:

Crotch Strap - page 28

Shoulder Strap - page 29

Always remove baby from Infant Carrier prior to making adjustments.

Press the harness adjuster and pull the harness straps to slacken.

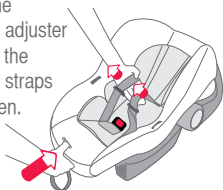

Buckle Tongue Holder (if fitted)

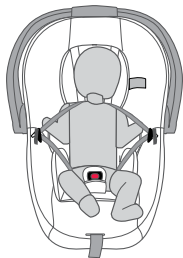
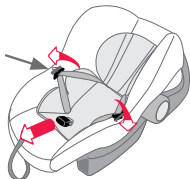

# INFANT CARRIER SETUP

The shoulder straps must be in the slots which are nearest to the child's shoulders, but not lower than the child's shoulders.

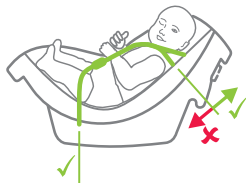

- F. Adjusting the shoulder harness, it is better to change one strap at a time so that the other strap will be a guide for re-assembly.

The shoulder straps must be in the slots which are nearest to the child's shoulders, but not lower than the child's shoulders.

**AVERAGE SIZE  
BABY**

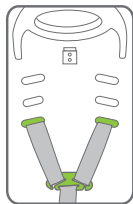

**GROWING  
BABY**

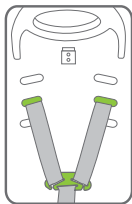

**LARGER  
BABY**

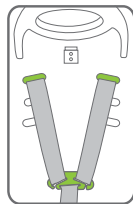

## **IMPORTANT :**

- Always adjust the height of the shoulder straps as the child grows
- Do not use the carrier with the harness shoulder straps set at different heights or fed through mismatching slots.
- Ensure the harness straps are not twisted and that all straps are secured by pulling each harness strap.

# HOW TO USE

## PLACING INFANT IN CARRIER

When positioning baby into Infant Carrier make sure baby's back is fully supported onto the flat section and the baby's nappy area (bottom) is resting in the bottom curvature as shown. It is recommended that bulky nappies are not used when baby is travelling in the Infant Carrier as they can cause incorrect positioning of the baby's back in the Infant Carrier.



Bottom curvature of Infant Carrier

- A. Loosen shoulder straps by pressing the harness adjuster and pull both shoulder straps evenly. Pull out the desired amount of slack.

Press the harness adjuster and pull both harness straps evenly to loosen.

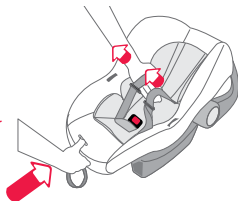

- B. Place the two harness tongues into the Buckle Tongue Holder (if fitted). Move the harness buckle towards the harness adjuster for easier fitment next time you put the infant in the carrier.

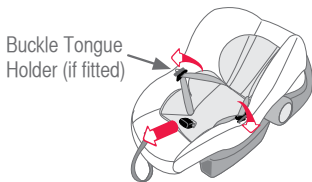



## HOW TO USE

- C. Place baby into Infant Carrier lying on its back so that the buckle is between the baby's legs. Ensure that baby's arms and legs are free. Make sure baby is dressed to allow the Harness Buckle to be pulled up between baby's legs e.g. a jump suit.

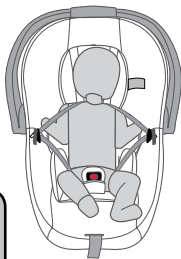

### NOTE:

1. Discontinue using the Padded Insert when shoulder straps are in the top slots or if the Pad causes over heating, discomfort or you need more room for baby to grow.
2. Correct fitment of the harness is very important as it restrains the baby in the Infant Carrier. The harness must fit firmly around upper torso of the baby and be positioned to leave the baby's arms and legs free.



### CAUTION:

Do not harness an infant wrapped in a blanket or swaddled as this increases the risk of ejection and injury or death in a crash. The harness needs to fit firmly to the baby, any blanket or other covering may be placed over the harness after the harness is adjusted. Arms and legs must be free and not bound. The legs must sit on each side of the crotch strap.

## HOW TO USE

- D. Place each arm through each shoulder strap of the harness. Position the buckle of the crotch strap as shown right.

- E. Fit either harness buckle tongues into the harness buckle followed by the other tongue. A click is heard when the last tongue is fully engaged.
- Should the second tongue not insert - press the red button and reinsert the tongues. Ensure secure engagement by pulling harness straps. If the harness buckle does not engage correctly then it may require cleaning or need replacement - refer to page 43. **The buckle tongues are fully engaged when both tongues are inserted and 'click' is heard.**

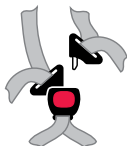
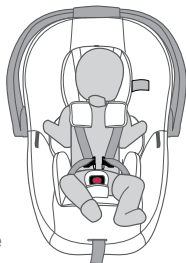

## HOW TO USE

- F. Ensure slack is removed from the lap straps by pulling the shoulder harness straps through the buckle tongues, then pull the Harness Adjustment Strap to take up the slack in the harness, adjusting to a firm but comfortable fit. Make sure that the baby's arms and legs are free and the crotch strap is between the legs. Check that slack in the straps is minimal.

Do not use the restraint if straps do not tighten. Contact Customer Service.

Pull Harness Straps through the buckle in direction of arrows

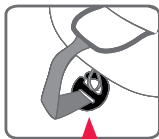
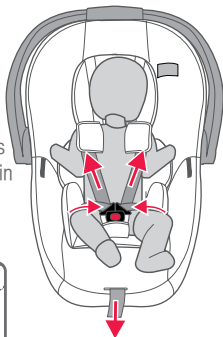

Pull harness adjustment strap to remove slack.

Hook the harness adjuster strap on to the loop to prevent tripping over the strap.



### **CAUTION: A LOOSE HARNESS IS DANGEROUS**

The end of the harness adjustment strap is connected to the cover to avoid tripping over the end when carrying the Carrier. Ensure the harness adjustment strap hook is attached when carrying the carrier.

The infant should be harnessed correctly whenever placed in the infant carrier. Do not carry an unrestrained infant in the infant carrier.



### **WARNING: DO NOT LEAVE CHILDREN UNATTENDED IN THE CAR.**

## HOW TO USE

## PLACING BABY & INFANT CARRIER ONTO BASE

- A. Position the Infant Carrier over the top of the installed base. Make sure the Harness Adjustment Strap is not caught between Infant Carrier and Base then lower the Infant Carrier into position.
- B. Push down on the Infant Carrier until an audible click is heard. Pull upwards on the Infant Carrier to check it is correctly locked into position.

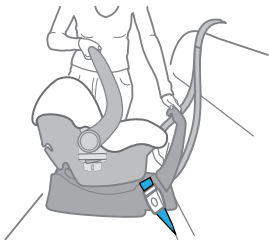

- C. Attach the top tether strap around the infant carrier by feeding through the handle and onto the top tether strap guides as shown.

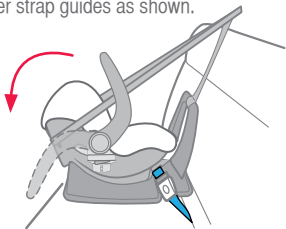
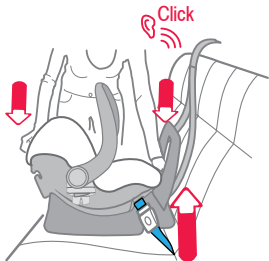

- D. The handle may be rotated into other positions if desired, although this may be difficult due to the front seat position.
- E. Always secure the loose end of the top tether strap in the pocket on the top tether strap to prevent it hanging out of the car or being accessible by the child.

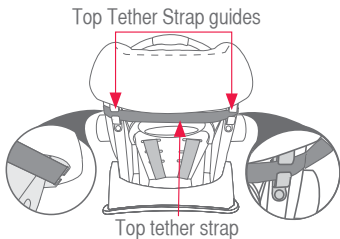



# HOW TO USE

## REMOVING BABY & INFANT CARRIER FROM BASE

- Loosen the top tether strap. Ensure that the adjuster and/or harness straps do not fall on the baby.
- Remove the top tether strap from the tether strap guides on the Infant Carrier.
- Place top tether strap between the stabilising bar and the car seat back so that it will not fall behind the seat or get trapped in the door. This will keep the top tether strap visible and ready for use when the Infant Carrier is put back in the car.
- Rotate the Carry Handle to the “carry position” as shown. Ensure the handle is locked.
- Grasp the handle with one hand then pull the Infant Carrier release catch with the other hand. With the catch lifted raise the Infant Carrier clear of the base.

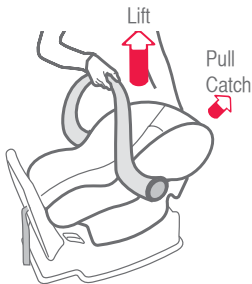

**Always ensure the handle is locked in position before lifting.**

- When the Infant Carrier is clear of the base, carefully remove it from the car.

Ensure the harness adjustment strap hook is connected to the loop.



### CAUTION:

The end of the harness adjustment strap is connected to the cover to avoid tripping over the end when carrying the Carrier. Ensure the harness adjustment strap hook is attached when carrying the carrier.

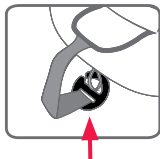

Hook the harness adjuster strap on to the loop to prevent tripping over the strap.

# HOW TO USE

## REMOVING BABY FROM INFANT CARRIER

- A. Rotate the carry handle to the "non-rocking position" and ensure the Canopy is fully open.
- B. Press the Harness Adjuster while pulling both shoulder straps evenly to loosen the harness.
- C. Press the red button on Harness Buckle to release both harness tongues. Place buckle tongues through buckle tongue holder's (if fitted) on each side of the cover or padded insert otherwise place straps on each side of the carrier clear of the infant.
- D. Feed the infants's arms through each side of the harness. Lift the baby out of the carrier.

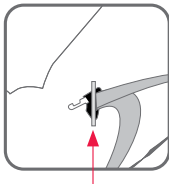
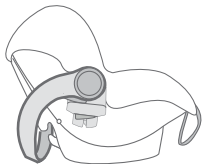

Buckle Tongue  
Holder (if fitted)

**NOTE:** Once the baby gets heavier you may wish to leave the carrier in the car. In this case you will need to disconnect or loosen the top tether strap before removing the baby.

# HOW TO INSTALL IN AN AIRCRAFT

## HOW TO INSTALL USING AIRCRAFT LAP BELT

The Infant Carrier without base is suitable for use on aircraft.

The Infant Carrier must be used in accordance with the aircraft operators procedures, and any directions from the aircraft operator, pilot or crew.

The Infant Carrier may not fit in smaller aircraft and cannot be used with aircraft seatbelts that contain airbags unless they can be disabled.

Inform the aircraft operator that a child restraint is intended to be used on the aircraft when booking the flight as the child restraint may not be suitable for use in that operator's specific aircraft.

Follow the instructions of the flight crew or pilot.

For use of the child restraint in cars in countries other than Australia and New Zealand, The user should consult the country's local authorities, car hire companies, car insurance companies, etc. for advice. The child restraint may not be acceptable for use in all cars.

## FIT THE INFANT CARRIER TO THE AIRCRAFT SEAT

The top tether strap is not required to be used to fit the child restraint in aircraft. You do not need the base onboard the aircraft. We recommend that you store the excess strap in the pocket provided and check-in the base with your luggage for use at the destination.

- A. Position the infant carrier rearward facing, align it centrally within the allocated seating position. If possible, lift the armrests out of the way to improve access to installing the aircraft lap belt and to suit the width of the carrier.
- B. Carefully remove cover on the side to reveal

### AIRCRAFT REARWARD-FACING BELT PATH label marked in green.

**NOTE:** Never use this path in a car.

### AIRCRAFT REARWARD-FACING BELT PATH marked in green.

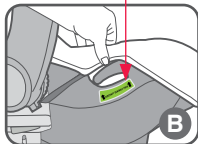

# HOW TO INSTALL IN AN AIRCRAFT

- C. Place handle in "non-rocking" position, that is, fully backwards. Fully lengthen lap belt. Thread the lap belt into **AIRCRAFT REARWARD-FACING BELT PATH** lap belt path (green marker) as shown, ensuring that lap part is below the hook as shown, on each side. Engage lap belt buckle and tongue.
- D. Push down on the infant carrier and remove all slack from the lap belt. Pull belt strap to tighten, ensure a firm fit of the infant carrier to the seat.

Do not use this restraint with aircraft seatbelt that contain airbags unless they can be disabled.

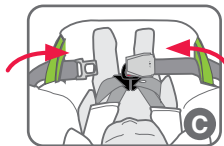
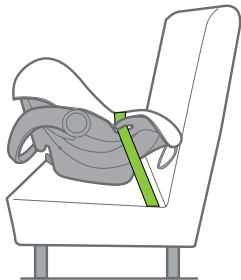

Ensure lap belt is under the hook on each side

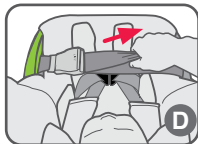
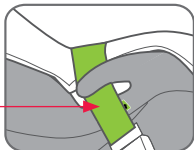

Remove slack





## HOW TO INSTALL IN AN AIRCRAFT

The infant carrier base may be included with 'checked in' luggage (for use after flight). Aircraft label is located on the underneath of the infant carrier. It demonstrates suitability for use on aircraft.



This Child Restraint System meets the standards for use in aircraft as recommended by the Civil Aviation Safety Authority of Australia and the Civil Aviation Authority of New Zealand.

Only to be used on aircraft with the permission of the aircraft operator, pilot and crew.

### SUITABLE FOR REAR FACING USE

The top tether strap is not required to be used onboard aircraft and should be stowed securely.



# CARE & MAINTENANCE

---

## REGULAR CARE OF THIS RESTRAINT:

Please check the following items regularly to ensure the safety of your child:

- A. Check the webbing straps for fraying,
- B. Check there are no cracks in moulding,
- C. Check the harness adjuster is operating and is clamping the webbing,
- D. Ensure the buckle is free of fluff, liquid or other matter that may enter the buckle slots. Clean the buckle if it is sluggish to engage. See next page.
- E. If any part of the restraint is cracked, broken or not operating seek repair immediately  
- contact Britax Customer Service 1300 303 330

## CLEANING CAR SEAT

Use only mild soap and water to clean all metal and plastic parts of the restraint. Do not use chemicals or cleaning agents.

**HARDWARE:** Use only mild soap and water to clean all webbing, metal and plastic parts of your child's restraint, using a damp cloth.

Do not use chemicals or cleaning agents. Do not try and place any hardware into a washing machine.

**STRAPS AND HARNESS:** We only recommend that you spot clean the straps/harness with a damp sponge. The harness straps can be soaked, however they must be thoroughly dried without excessive heat (never tumble dry). The harness straps should not be placed in a washing machine as this may cause damage to the stitching or even damage your washing machine.

**COVER:** The restraint has a flame retardant cover which is removable for cleaning, please clip the hook and loop together on the cover and seat pad (if supplied) to prevent any damage to the cover when washing. Cleaning instructions are on the care label attached to the cover. For machine washable covers, use gentle cycle, cold water only, rinse well and dry on a flat surface. Do not tumble dry, do not bleach or dry-clean. May be hand washed. Follow the care label on the cover.

To keep your product looking its best, take care when using while wearing jewelry or other items that could snag.

# CARE & MAINTENANCE

## BUCKLE OPERATION

To ensure the buckle remains operational the inside must be kept free of liquids, sand, dirt, fluff, food or similar substances. If the buckle is not operating or you do not hear a strong audible click when the second tongue is inserted, the buckle needs to be washed or replaced. The buckle is fully engaged when both tongues are inserted. Contact Customer Service for assistance.

## TO CLEAN HARNESS BUCKLE:

If sticky liquids such as baby formula, fruit juice, etc. get inside your harness buckle, it may become sluggish. An indication of a sluggish harness buckle is that you cannot hear a click when engaging the final harness tongue. To restore the harness buckle to good working order it needs to be cleaned as follows:

- Remove the harness buckle from the restraint: From the underside of the restraint pull each crotch strap 3-bar slide, turn the 3-bar slide on its side and push back through the slot.
- Place the harness buckle under warm (max. 40 degrees Celsius) running water as shown below. Let the water run through the mouth of the buckle for five minutes. Check the harness buckle is clean by engaging the harness tongues and buckle several times until you hear a click.
- If you still cannot hear a strong audible click then repeat the cleaning process several times.
- Refit the harness buckle to the restraint ensuring the red button facing outwards and the 3-bar slide is fed through the same slots.

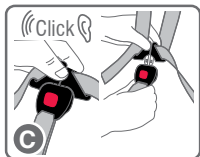
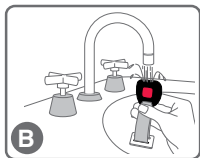
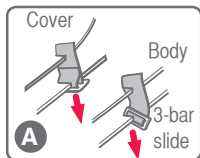

**If the Harness Buckle cannot be returned to its original working condition then contact BRITAX Customer Service for assistance.**



## CARE & MAINTENANCE

---

### COVER (STYLE MAY VARY)

The restraint has a flame retardant cover which is removable for cleaning. Cleaning instructions are on the care label attached to the cover. If a fluffy cover is fitted then washing the cover prior to use will remove excess fluff.

The cover has been designed to protect your child when seated in the restraint. Care should be taken if children either eat or drink while in the restraint as some food or drink products may cause damage or marking to the cover. Wash or clean immediately. Do not pull sticky items from covers as the cover may be damaged - soak in water and gently remove.



### **VERY IMPORTANT:**

**Only replace the cover with a Safe-n-Sound supplied replacement cover with identical shoulder height markers or a replacement cover meeting AS/NZS 8005.**

# CARE & MAINTENANCE

## TO REMOVE THE COVER

- A. Remove the Canopy by unclipping the press studs from the carry handle (see page 20). Remove any baby insert pad and head pillows (if supplied) as described on page 48 to 49.
- B. Disconnect the shoulder harness straps from the Metal Strap Connector and feed through shoulder slots in both infant carrier and cover. Refer to page 38.
- C. Feed the shoulder harness straps and tongues through lap strap slots in the cover only. There is no need to remove the harness straps from the Infant Carrier.
- D. Lift the cover around the rim of the infant carrier at the harness adjuster end, feed the crotch buckle through the slot in cover and pull the harness adjuster strap out of the slots.
- E. Remove the cover for cleaning.

Unclip press studs on carry handle to remove canopy

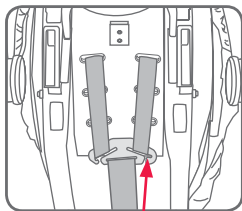
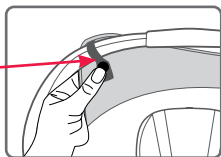

Metal Strap Connector

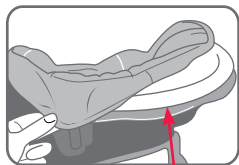

Pull elastic cover over Infant Carrier

# CARE & MAINTENANCE

## TO REPLACE THE COVER

- A. Place the cover over the infant carrier ensuring all slots in cover line up with slots in infant carrier.
- B. Ensure that there are no twists in all straps underneath the Infant Carrier.
- C. Feed the shoulder harness straps through lap strap slots in cover.
- D. Feed the shoulder harness straps through the shoulder strap slots in cover and then through the Infant Carrier. Re-attach the straps to metal strap connector at the back of the seat. Refer to page 30 to 31 for harness setup for your baby. Attach the shoulder harness straps to the strap connector.
- E. Feed the crotch buckle through the slot in trim and then through the crotch pad attached to the cover.  
Feed the harness adjuster strap through the slots in the cover.
- F. Refit and clips around the cover to the infant carrier.
- G. Engage shoulder harness tongues and crotch buckle. Pull to check harness is attached. **Ensure the straps are not twisted.**
- H. Replace any baby insert pad and head pillows (if supplied). To Replace Canopy refer to page 20.

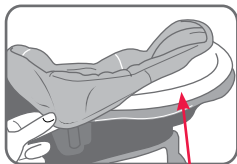

Pull elastic cover over Infant Carrier

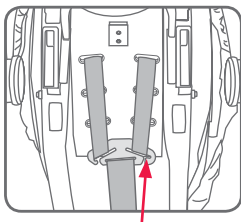

Metal Strap Connector

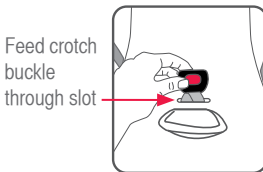

Feed crotch buckle through slot

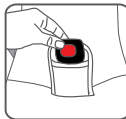
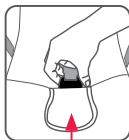

Feed though crotch pad attached to cover



## ACCESSORIES

Only use accessories designed and recommended by Britax Childcare Pty Ltd for this product series number - 40/B/2013.

Use of aftermarket accessories, that is, accessories not provided with this child restraint can reduce the safety of the child restraint and may cause injury or death. Always follow the instructions covering the use of accessories in this section or the instructions provided with accessory. If an aftermarket accessory is used that is not recommended by Britax then ensure that the accessory is for this restraint, compliant with AS/NZS 8005 and stated as suitable for use with this child restraint.

The following instructions apply to accessories that may be supplied with this restraint at point of purchase. If not, a variety of Safe-n-Sound accessories are available from various retailers of Safe-n-Sound products.

### PADDED INSERT - Style may vary

Some models have a separate Padded Insert inside the Carrier for additional comfort.



#### CAUTION:

Shoulder straps and/or lap straps must pass through any harness slots in the insert.

Depending on the style of insert, it may need to be fitted by removing the shoulder straps, refer to page 29.

Failure to do this might result in the harness not holding the child securely.

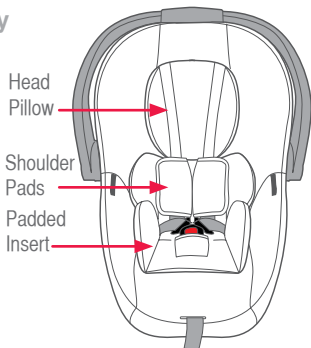

### SHOULDER PADS - Style may vary

The shoulder pads may require release by press studs. If fully fitted to the shoulder strap then you will need to disconnect the shoulder strap as described on page 30 to 31.

## ACCESSORIES

### HEAD PILLOW - Style may vary

The head pillow is only required for supporting the smaller baby and can no longer be used once the harness shoulder straps are in the top pair of slots. The pillow is fitted to the carrier by elastic and clips on the back of the pillow being threaded through the slots above the harness shoulder strap. Ensure the elastic and clips are threaded through slots in the backrest of the main moulding.

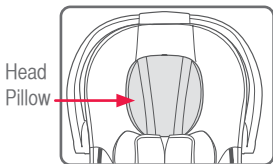

### CANOPY

Refer to page 20.

Elastic with clips  
over infant carrier  
and through slots

Shoulder harness

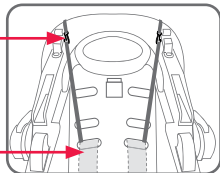

### EXTRA BASE

An Extra Base is available as a separate purchase for a second car. This allows the Carrier to be easily and quickly switched between cars. The top tether strap is supplied with the Base.

An ISOFIX compatible base must not be used with this carrier. Use a base with the series number 40/B/2013 marking only.

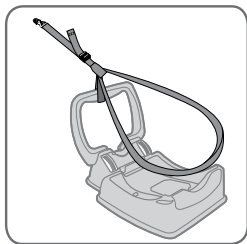



## INSTALLATION OF CAR'S UPPER ANCHORAGE POINT

Consult the vehicle owner's handbook for location of anchorage fittings or anchorage points and the possible use of spacers. Some vehicles may have an anchor fitting fitted by the vehicle manufacturer. If anchorage points cannot be found refer to car manufacturer or local child restraint fitting station or traffic authority for optimum position of upper anchorage point and the use of spacers.

### UPPER ANCHORAGE STRAP



#### **IMPORTANT:**

THE ATTACHMENT CLIP COVER MUST ALWAYS BE USED AS IT PREVENTS THE RISK OF INCORRECT FITMENT OF THE ATTACHMENT CLIP TO THE UPPER ANCHORAGE POINT. ALWAYS ENSURE THAT THE ATTACHMENT CLIP IS CORRECTLY ENGAGED TO THE UPPER ANCHORAGE POINT AND NOT HOOKED OR FITTED TO ANY OTHER OBJECT BEFORE EACH USE OF THE RESTRAINT. THIS IS ESPECIALLY IMPORTANT IN VEHICLES SUCH AS STATION WAGONS, VANS, HATCH BACKS OR VEHICLES WITHOUT A FIXED PARCEL SHELF, SINCE THE ANCHOR POINT IS USUALLY NOT VISIBLE.

#### **IMPORTANT INSTALLATION NOTE:**

In some vehicles the upper anchorage point in the rear vertical panel can only be installed in one way. Please refer to vehicle owner's handbook or a child restraint fitting station for correct method.

# INSTALLATION OF CAR'S UPPER ANCHORAGE POINT

Extension Strap distance to be measured.

Length 300mm (Use Safe-n-Sound part 0035 or equivalent).

Length 600mm (Use Safe-n-Sound part 0036 or equivalent).

Available from all major child restraint retailers.

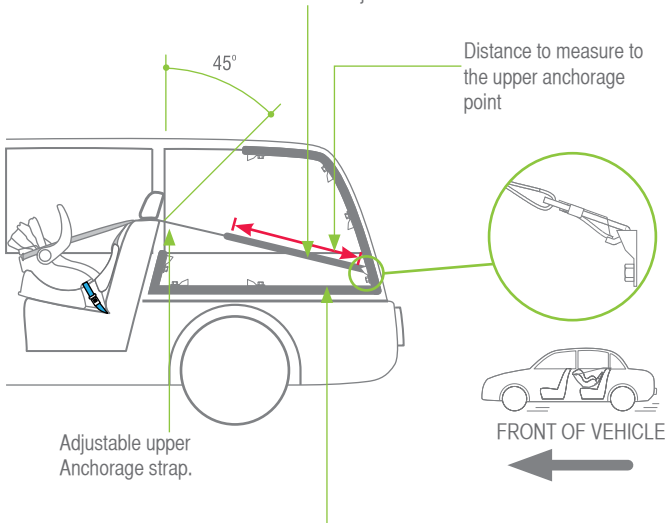

The shaded areas of this diagram illustrate the possible locations of the upper anchorage point. Within each shaded area is an upper anchorage point showing the correct way to install the fitting. Ensure the upper anchorage point is aligned as illustrated unless stated otherwise in the vehicle owner's handbook.

## INSTALLATION OF CAR'S UPPER ANCHORAGE POINT

### IF THE CAR IS FITTED WITH CHILD RESTRAINT UPPER ANCHORAGE POINT

Locate the upper anchorage point behind the rear seating position. (Consult the car owners handbook for the location of the upper anchorage point). The upper anchorage point should be directly behind and central to the restraint. Remove thread plug from the parcel shelf/floor/roof, etc. and install attachment bolt and fitting as shown in Fig 1.

**CAUTION: DO NOT OVERTIGHTEN ATTACHMENT BOLT. OVERTIGHTENING MAY FRACTURE OR BREAK BOLT. MAXIMUM TORQUE IS 20 Nm(14.75 ft.lb.)**

Note: Minimum of five full turns of attachment bolt is required before tightening force is applied.

**UPPER ANCHORAGE FITTING**  
**Fig.1.**

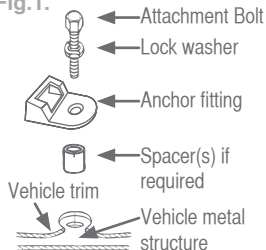

# INSTALLATION OF CAR'S UPPER ANCHORAGE POINT

## IF THE CAR IS NOT FITTED WITH CHILD RESTRAINT UPPER ANCHORAGE POINTS

**For Sedans only** - Drill 9mm diameter hole in the parcel shelf on the centre line of the seating position as shown in Fig 3. Before drilling the hole, check the underside for accessibility. Install the attachment bolt as shown in Fig 2. It is recommended that this installation be carried out by a child restraint fitting station or licenced motor mechanic.

**For vehicles other than Sedans** - In Australia, consult your nearest child restraint fitting station or traffic authority for vehicle inspection to find the best, correct position for the placement of the upper anchorage point, and for the correct attachment bolt length and use of spacers. In New Zealand, consult the agent for the vehicle. Note to Queensland purchasers: The installation of anchorage points must be approved by authorised officers appointed by Queensland Transport. Authorised officers can be sourced from all Queensland Transport Customer Service and Queensland Ambulance Service Centres.

UPPER ANCHORAGE FITTINGS FOR SEDANS ONLY  
Fig.2.

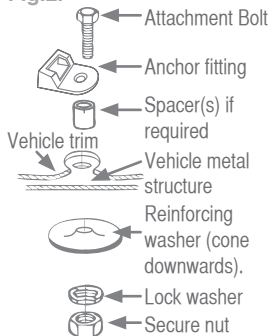

Front of Vehicle

## INSTALLATION OF CAR'S UPPER ANCHORAGE POINT

ONLY USE A 5/16 UNC GRADE 5 BOLT. IF THE BOLT IS NOT THE CORRECT LENGTH THE CAR MANUFACTURER'S HAND BOOK CAN PROVIDE ADVICE ON THE CORRECT LENGTH BOLT.



### WARNING

CHILD RESTRAINTS MUST NOT BE ATTACHED TO UNSOUND METAL OR TO WOOD, OR SYNTHETIC STRUCTURES. WHEN DRILLING 9 MM HOLE DO NOT DRILL THROUGH FUEL LINES, FUEL TANKS, ELECTRICAL WIRING, OR RADIO SPEAKERS.

WEBBING STRAPS MUST BE PROTECTED FROM SHARP CORNERS AND EDGES. THE ANCHOR FITTING MUST BE USED ONLY AS DESCRIBED ABOVE. IT MUST NOT BE HOOKED ONTO ANY OTHER OBJECT.



NOTE: Marking on the top of a Grade 5 Bolt. Do not use any bolt without these marks.



Front of Vehicle

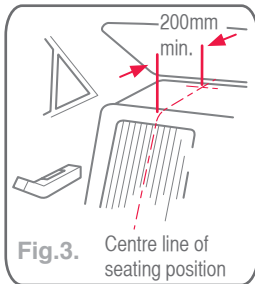

Fig.3. Centre line of seating position

## CAR INSTALLATION ACCESSORIES

(From retailers of Safe-n-Sound products)

**EXTRA ANCHOR KITS:** Available for using the restraint in additional cars.

Re-order no: 0038

**EXTENSION STRAPS:** May be required for cars without a fixed parcel shelf.

Re-order no: 0035 (length 300mm) or

0036 (length 600mm)

**GATED 3-BAR SLIDE (Locking clip):** For converting lap-sash seat belt to lap belt, and to obtain a better fit to the car where the fitted lock-off may not be suitable. Most cars will not need this. Re-order no: 0215.

## ALTERNATIVE INSTALLATION IF SEATBELT LOOSENS

### LAP-SASH SEAT BELT

If a seat belt will not stay tight, then a Gated 3-Bar Slide may be used to prevent loosening.

Obtain this part from most retailers of Safe-n Sound products.

There may be two types of Gated Slides available, Curved and Flat.

Before using the restraint, convert the lap-sash seat belt by using the Gated 3-Bar Slide.

- A. Hold the lap and sash straps together and fold as shown. Slide the inner strap into the Gated 3-Bar Slide followed by the outer strap.

- B. The two straps should slide freely in the Gated 3-Bar Slide slot.

- C. Repeat previous step A for the other slot in the Gated 3-Bar Slide.



Curved

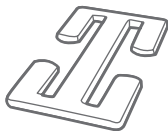

Flat

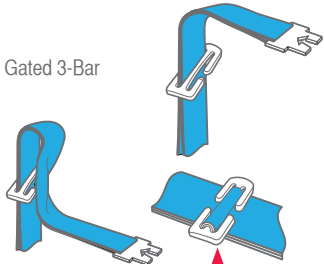
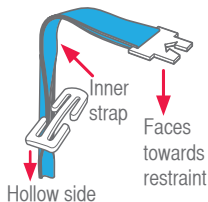

## ALTERNATIVE INSTALLATION IF SEATBELT LOOSENS

- D. Feed the straps through the Gated 3-Bar Slide to remove any slack.

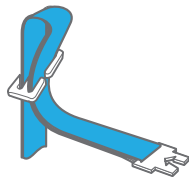

When fitting the Curved Gated Slide, the seat belt route can only go one way, as shown above.

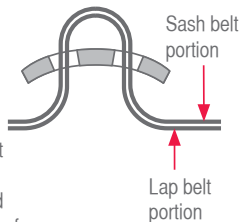

Use this seat belt configuration to install the child restraint according to the instructions on pages 27 to 28. Remove all slack in the lap belt to ensure the base is held firmly against the seat back. This may require adjustment of the strap through the gated 3-bar slide.



### IMPORTANT:

Remove the gated 3 bar slide from the seat belt as soon as the child restraint is removed so that an adult can use the seat belt as a lap-sash seatbelt.

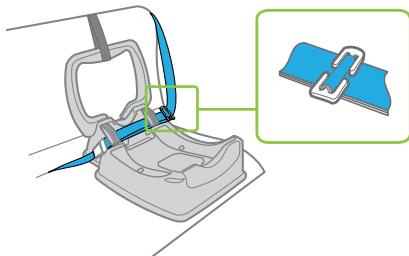



# TRAVEL SYSTEM

---

This Infant Carrier is designed to be connected to compatible strollers. The following pages provide general instructions about using the Infant Carrier with a stroller which may differ slightly for some strollers. Refer to the attachment instructions provided with your stroller. Use the stroller in accordance with the instructions supplied with the stroller. This Infant Carrier will not fit all strollers.

There are two methods of connecting the Infant Carrier to the stroller. Check with the stroller instructions or promotional literature to see which system applies.

- Integral latch which fits to the arm bar or tray, or
- Britax CLICK & GO™ Adaptor that fits to the receivers on the stroller side armrests.

The stroller instruction manual will provide full instructions on use of the stroller.



## WARNINGS

**DO NOT LEAVE THE CHILD IN THE INFANT CARRIER FOR EXTENDED PERIODS. THE TRAVEL SYSTEM INFANT CARRIER IS DESIGNED TO PROVIDE MOBILITY OUTSIDE OF THE CAR BUT IT SHOULD NOT BE USED IN PLACE OF AN APPROPRIATE COT.**

**THE INFANT CARRIER MUST ONLY BE USED WITH STROLLERS WITH COMPATIBLE ATTACHMENTS. WE RECOMMEND SAFE-N-SOUND AND STEELCRAFT STROLLERS.**

**IF IN DOUBT ABOUT THE METHOD OF INSTALLATION, CONTACT BRITAX CHILDCARE CUSTOMER SERVICE ON 1300 303 330 AU/ 0508 688 822 NZ.**

**Always ensure the baby is secured in the Carrier with the harness at all times.**

**Do not carry an unrestrained baby in the infant carrier.**





# TRAVEL SYSTEM INTEGRAL LATCH

## INSTALLATION INSTRUCTIONS PREPARING THE INFANT CARRIER - LATCH METHOD

You may need to remove the Britax Click & Go™ Adaptors (see page 62 to 62) to enable fitment on some strollers when using the integral latch system.

- Remove baby from Infant Carrier.
- Rotate handle into "carry position", then lift the release catch with the other hand.
- With the release catch depressed lift the Infant Carrier clear of the base hooks, and remove from the car.

## PREPARING THE STROLLER

- Ensure the Stroller has been assembled correctly.
- Open the Stroller, apply the brakes.
- Before fitting the Infant Carrier check and ensure all latches are engaged to prevent the stroller folding inadvertently.
- Lower the backrest to the fully reclined position.
- Remove the arm bar cover and store in the basket pocket.

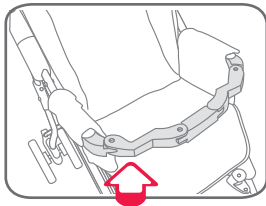

Arm Bar cover removed

\* Refer to page 19 for handle position

# TRAVEL SYSTEM

## INTEGRAL LATCH

### INSTALLING THE INFANT CARRIER INTO THE STROLLER - LATCH METHOD

- Ensure that the arm bar (or tray) is fully locked in position on both sides of the armrests.
- Position the Infant Carrier over the Stroller with the baby's head end of the Infant Carrier over the Stroller arm bar (or tray).
- Lower the Infant Carrier and ensure that it locates onto the Arm Bar, (or tray) and the latches engage.

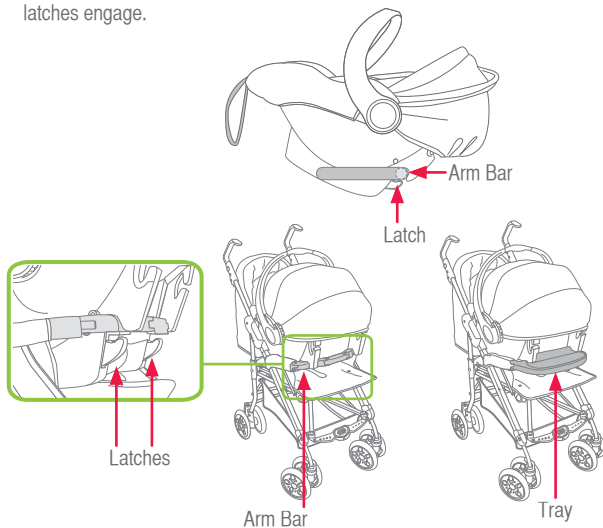



## TRAVEL SYSTEM INTEGRAL LATCH

- D. Then lower the foot end of the Infant Carrier until it rests on the seating surface of the stroller.
- E. Check the carrier is securely attached to the stroller arm bar by lifting the carrier before use.
- F. Fold the infant carrier handle down if required.

**NOTE: Do not lift the stroller by the carrier as it may disengage.**

Refer to the Stroller instruction book for all other instructions.

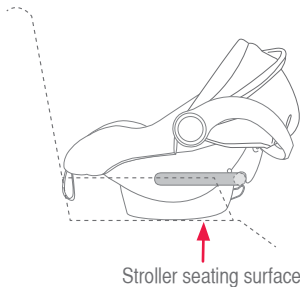

### REMOVING THE INFANT CARRIER FROM THE STROLLER

- A. Rotate the Infant Carrier handle to the "carry position" and grip firmly in one hand.
- B. Raise the Infant Carrier release catch located on the rear of the Infant Carrier.
- C. Lift the Infant Carrier clear of the stroller.

ENSURE THE BABY IS SECURED IN THE INFANT CARRIER WITH THE HARNESS AT ALL TIMES. THE INFANT CARRIER IS FITTED WITH A CANOPY WHICH CAN BE USED WHEN THE CARRIER IS CONNECTED TO THE STROLLER. THE CANOPY CAN ALSO BE USED IN THE CAR.

\* Refer to page 19 for handle position

# TRAVEL SYSTEM

## BRITAX CLICK & GO™ ADAPTOR

### ATTACHING THE INFANT CARRIER TO THE STROLLER FRAME

If the Infant Carrier is fitted with Britax Click & Go™ Adaptor, then fit as follows:

- A. Remove Stroller seat or Carry cot from stroller frame (refer to your stroller instructions).
- B. The Infant Carrier will only fit the stroller in one direction. The infant carrier must face the Stroller handle. With the Infant Carrier handle in the upright position, just place the Click & Go™ adapters over the stroller frame sockets and push the Infant Carrier into the socket. The adapters will lock the carrier to the stroller.

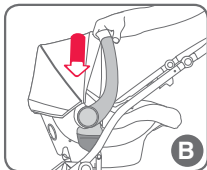

Secure your baby into the Infant Carrier with the harness provided on the infant carrier.



#### **IMPORTANT :**

Only use Infant Carrier with compatible Britax/Steelcraft Stroller or with other brand strollers that have an approved Britax Click & Go™ receiver.

Pull upwards on both sides of the Infant Carrier to confirm it is locked into the frame. If not locked on both sides, repeat above steps.

# TRAVEL SYSTEM

## BRITAX CLICK & GO™ ADAPTOR

### RELEASING THE INFANT CARRIER FROM THE STROLLER FRAME

- A. Squeeze both carry handle release latches and rotate the handle upwards, into the “carry position”.
- B. Squeeze the left and right triggers of the Click & Go™ adaptors on your Infant Carrier with both hands. De-latch the Infant Carrier from the stroller frame.

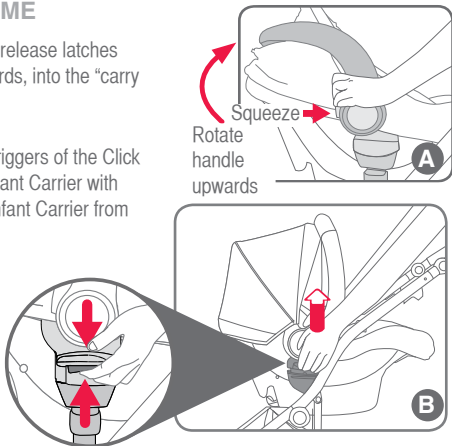

- C. Lift and remove the Infant Carrier away from the frame.



### CAUTION:

Never fold the stroller frame with an infant carrier attached.  
Remove the Infant Carrier before folding the stroller frame.

\* Refer to page 19 for handle position

# TRAVEL SYSTEM

## BRITAX CLICK & GO™ ADAPTOR

### HOW TO REMOVE THE BRITAX CLICK & GO™ ADAPTOR

To remove the Britax Click & Go™ Adaptor, ensure handle is in “rocking position” ②.

Cover removal is not necessary.

- A. Lift out the plastic flaps on both sides of the infant carrier cover next to the handle pivot.
- B. Carefully remove the screw with a screw driver. Remove the Locking Pin. Pull out the adaptor from carry handle.

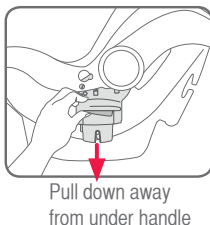
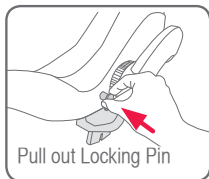
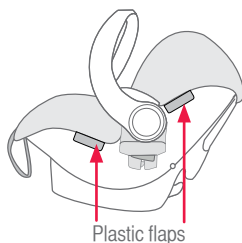

- C. Store for future use with these instructions.

\* Refer to page 19 for handle position

# TRAVEL SYSTEM

## BRITAX CLICK & GO™ ADAPTOR

### HOW TO REPLACE THE BRITAX CLICK & GO™ ADAPTOR

- A. To attach the Britax Click & Go™ Adaptor to the Infant Carrier ensure the Carrier Handle is in “Rocking position” ②, disconnect the elastic under the handle and pull the trim away from the side of the carrier to align the holes.

Handle pivot

- B. Align the Adaptor in the recess under the handle pivot, push up and click into place.

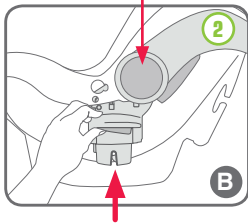

Push in under handle

- C. Insert Locking Pin into hole. Align both top and bottom holes.

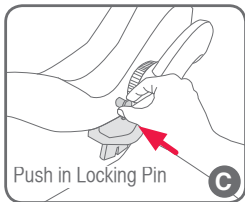

Push in Locking Pin

- D. Locate screw into the bottom hole and tighten with screw driver. Do not overtighten.

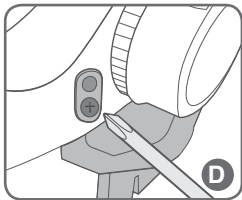

\* Refer to page 19 for handle position

# TRAVEL SYSTEM

## BRITAX CLICK & GO™ ADAPTOR

---

- E. Replace the trim by tucking the plastic flaps back underneath the shell edge.

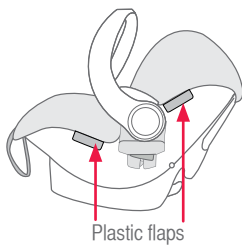





# TRAVELLING TIPS

---

## SAFETY

Never hold a baby in arms when riding in a motor vehicle. In this position the baby could be thrown against the dashboard, windscreen or other occupant and suffer serious injury or death.

When riding in a motor vehicle never nurse a baby and use the same seat belt for both of you. In this position the baby or child could be crushed.

Never breast feed a baby while car is in motion.

Children must be secured in appropriate restraints at all times when the car is in motion. Children travelling unrestrained and standing up in the car are in danger of serious injury or death. Traffic regulations in all states require children to be secured in child restraints or adult seat belts where available.

Plan your trip with frequent comfort stops to reduce stress on babies, young children and driver. Keep the car well ventilated to reduce heat stress. Car windows should be kept open to maintain a good flow of fresh air.

Never leave babies or toddlers in a stationary car because of the risk of heat exhaustion.

Ensure babies and toddlers are adequately shaded from direct sunlight through side or rear windows.

Check the car is ventilated by use of open windows or using the car's ventilation system taking in external air. Recirculation setting is not suitable for providing ventilation.

Be on guard against carbon monoxide poisoning which can occur through only a slight leak in the exhaust system while travelling in a closed car.

Securely stow all heavy objects, feeding bottles, etc. that could become missiles during an accident and cause injury to any occupant.

## CLOTHING/BATHING

Since it is often warmer in the car, dress the baby in light clothing.

Do not harness an infant wrapped in a blanket or swaddled. Any blanket or wrap must only be placed over the harness and infant.



## IN CASE OF CRASH

If your restraint has been involved in a severe crash, you should destroy the restraint even if no damage is obvious. Some insurance companies offer vehicle insurance which covers or partially covers the replacement of your child restraint. Contact your insurance company for further details. Your insurance company may require you to keep the child restraint for assessment, **but do not use the child restraint after a severe crash.** To assist you in making an accident insurance claim cut the following statement and include it with your claim.

### NOTICE TO INSURANCE COMPANY CHILD RESTRAINT INVOLVED IN AN ACCIDENT

This Safe-n-Sound child restraint is manufactured to Australian/New Zealand Standards AS/NZS1754-2013 which requires us to advise users of child restraints to "Destroy the entire restraint if it has been in use in a severe crash, even if no damage is obvious". The joint Australian/New Zealand Standards committee CS/85, advise that this statement applies whether a child was in the child restraint or not. We consider a "severe crash" as being one where the main body structure of the vehicle is distorted.

There is no method of determining if the restraint has been damaged and we concur with the Australian/New Zealand Standards in recommending destruction of the child restraint.

This notice is to advise you of the requirements of the Australian/New Zealand Standards and our obligation in complying with the standards.

Please assist the owner of this restraint in their claim.

#### **Britax Childcare Pty. Ltd.**

(Incorporated in Victoria)

A.B.N 55 006 773 600

Head office and registered address:

99 Derby Road Sunshine Victoria 3020

PO Box 147 Sunshine Victoria 3020

Telephone: 1300 303 330

[www.britax.com.au](http://www.britax.com.au)

New Zealand Office

Britax Childcare NZ Limited.

Telephone: 0508 688 822

[www.britax.co.nz](http://www.britax.co.nz)



# IN CASE OF CRASH

## CRASH EXCHANGE

We would never want you to experience an accident, but unfortunately accidents do happen.

If you experience an accident you may be eligible for a free replacement.

The Safe-n-Sound Crash Exchange Program is a voluntary program designed to ensure that our children are safe and that any seat that may have experienced a severe crash is taken out of the market.

There is no method of determining if the restraint has been damaged in a severe crash, so the restraint should be destroyed as the crash may reduce the child restraints ability to perform.

Since its inception in 2006, the Crash Exchange program has helped 100's of families ensure that their children have new restraints and that the restraints are not sold second hand placing others at risk.

Our Crash Exchange Terms and Application form are accessible on our website. Please visit [www.britax.com.au](http://www.britax.com.au) for further information.

### AUSTRALIA

Britax Childcare Pty. Ltd.  
A.B.N 55 006 773 600

#### Head office and registered address

99 Derby Road, Sunshine, Victoria 3020.  
PO Box 147 Sunshine, Victoria 3020.

**Customer Service** 1300 303 330

**Email** [au-custserv@britax.com](mailto:au-custserv@britax.com)

**www.britax.com.au**

### NEW ZEALAND

Britax Childcare (NZ) Ltd.

**Customer Service** 0508 688 822

**Email** [nz-custserv@britax.com](mailto:nz-custserv@britax.com)

**www.britax.co.nz**

## INTERNATIONAL ENQUIRIES

Contact your local Distributor.





Unity Neos™

Scan QR code for Quick  
Guide and Video installation

britax  
safe·n·sound

The Safe-n-Sound, Unity trademark is the property of Britax Childcare Pty. Ltd. (Australia).  
The BRITAX and Click & Go trademark are the property of Britax Childcare Holdings Ltd, UK.  
We reserve the right to alter this product without notice.  
© 2002-2015 Britax Childcare Pty. Ltd. Patent Pending.

Part No.2202467/B

47