

○



britax safe·n·sound

Scan for instructions

UNITY™

INFANT CARRIER
Birth to 12 months (approx.)
Instructions for Installation & Use
Series No. 40/A/2013



Suitable for
premature and
low birth weight
babies.



ISOFIX
COMPATIBLE

Optional Installation where fitted

NOTE: Style may vary from image shown.



**IMPORTANT: KEEP THIS BOOKLET IN THE PLACE
PROVIDED ON THE CHILD RESTRAINT BASE**

QUICK SETUP WITH SEATBELT

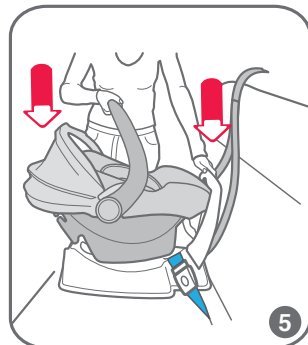
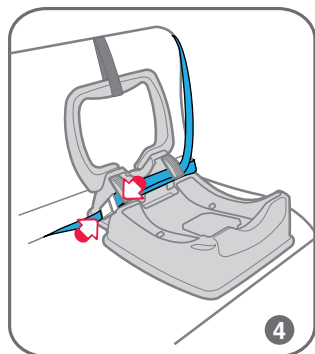
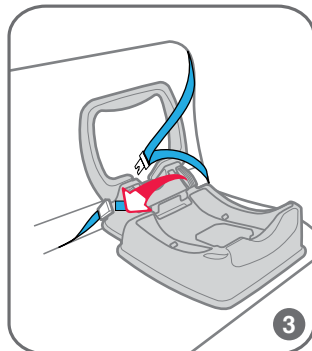
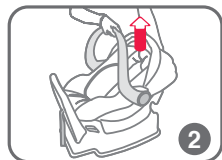
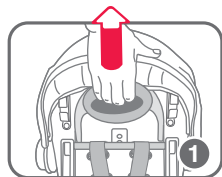

SEE PAGE 25 - 30 FOR FURTHER INFORMATION

QUICK SETUP WITH SEATBELT

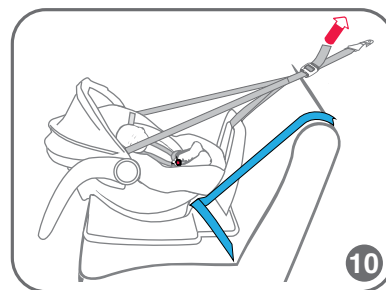
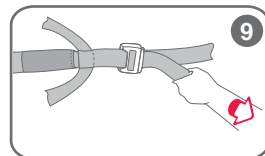
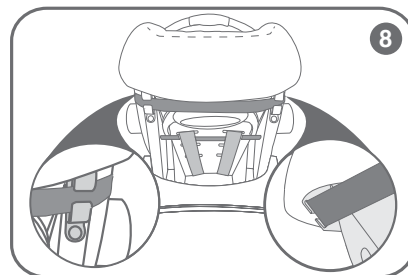
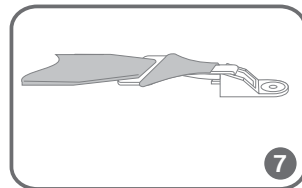
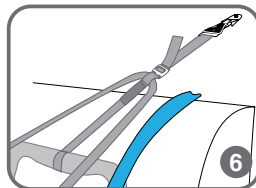

SEE PAGE 25 - 30 FOR FURTHER INFORMATION

QUICK SETUP WITH ISOFLEX™ STRAPS

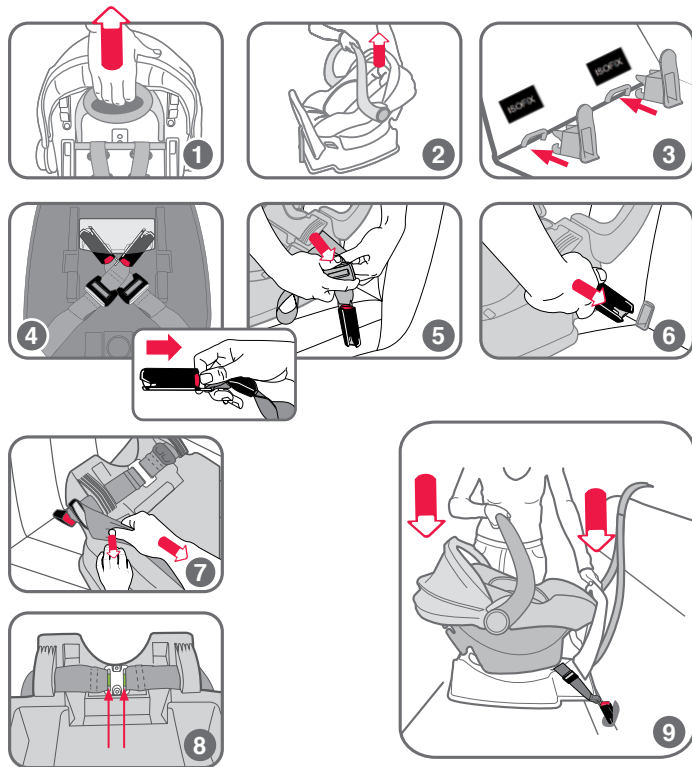

SEE PAGE 31 - 33 FOR FURTHER INFORMATION

QUICK SETUP WITH ISOFLEX™ STRAPS

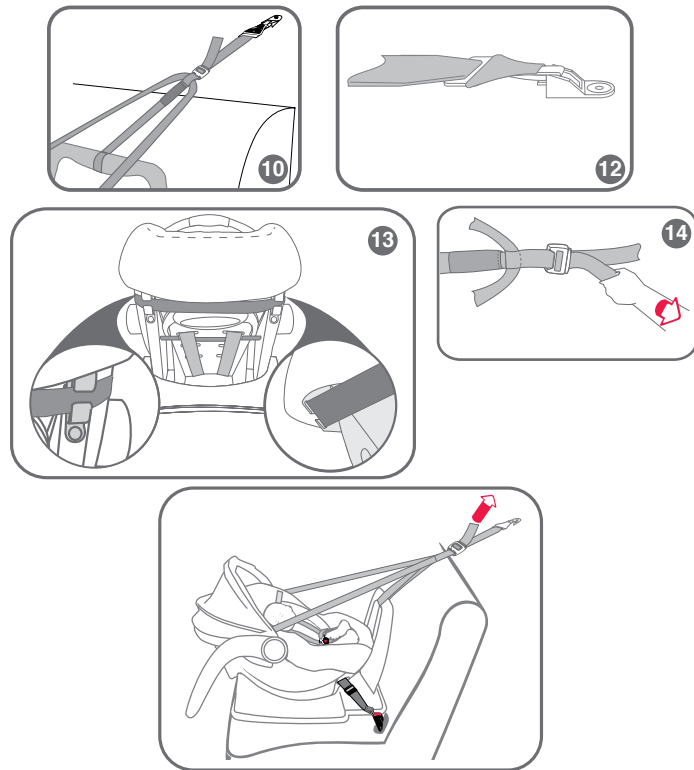

SEE PAGE 31 - 33 FOR FURTHER INFORMATION

INTRODUCTION

Suitable for low birth weight and premature infants without restrictive medical conditions. To be used only in a rearward-facing position until the infant's shoulders reach the shoulder height marker (approximately 12 months of age). Continue to use this infant restraint until the child reaches this limit. Infants are at risk of serious injury if they face forward too early.

متي. ةديديقت قيبط طورش نودب نيرستبملم اضرلو ضفخنلم ةدالولو نزول بسانم
 ةقالع ىلإ عضرىلما فيتك لصي ىتح فخلخا لىل ةاوله ةي عضرولا في طقف مءادخسا
 (مءه 12 مءع في فاكىرقت) فاكلك اءعافترا
 "ءءا اءه ىلإ لىل لفظل لوصو نيءل اءه عضرلما زءا ءمءءسا في رمءسا
 مءم اىل ةمءه ءوت اءا ءريظالم ءال باصاىلما ىلإ ضرعءءل ءرطاخم في عضرلما نوكي
 مءم اىل ءمءه رءك اءرءم ءرءوب

适用于没有严格医疗条件的低出生体重婴儿和早产儿。只采用后向式安装，直到婴儿的肩膀达到肩高标记（大约12个月的宝宝）在儿童达到该座椅上限以前必须不断使用这一婴儿汽车座椅。婴儿过早乘坐前向式座椅则可能受到严重的伤害。

Κατάλληλο για βρέφη με χαμηλό βάρος κατά τον τοκετό και πρόωρα βρέφη χωρίς περιοριστικές ιατρικές παθήσεις. Να χρησιμοποιείται μόνο σε θέση στραμμένο προς τα πίσω μέχρι οι ώμοι του βρέφους να φτάνουν στο δείκτη ύψους ώμου (περίπου 12 μηνών).

Συνεχίστε να χρησιμοποιείτε αυτό το σύστημα συγκράτησης νηπίων μέχρι το παιδί να φτάσει σε αυτό το όριο.

Τα βρέφη κινδυνεύουν με σοβαρό τραυματισμό αν κοιτάζουν προς τα εμπρός πολύ νωρίς.

Angkop para sa mabababa ang timbang nang ipinanganak at mga napaagang ipinanganak na mga sanggol na walang naghihigpit na kondisyong medikal. Gamitin lamang sa isang nakaharap sa likod na posisyon hanggang sa maabot ng balikat ng sanggol ang marka ng taas ng balikat (humigit-kumulang 12 na buwang edad).

Ipapatuloy ang paggamit ng pampigil ng sanggol na ito hanggang sa maabot ng bata ang limitasyong ito.

Ang mga sanggol ay nasa seryosong peligro ng pagkapinsala kung sila ay haharap ng masyadong maaga.

INTRODUCTION

Phù hợp với bề sơ sinh nhẹ cân và bề sinh thiếu vắng không có tình trạng sức khỏe giới hạn. Chỉ được sử dụng ở vị trí hướng mặt về phía sau cho đến khi vai của bé cao tới vạch ghi độ cao của vai (khoảng 12 tháng tuổi).
Hãy tiếp tục sử dụng ghế em bé này cho đến khi em cao tới giới hạn này.
Bé sơ sinh có nguy cơ bị chấn thương nghiêm trọng nếu hướng mặt về phía trước quá sớm.

जन्म के समय कम भार वाला और समय से पहले जन्मे शिशु के लिये अगर कोई स्वास्थ सम्बन्धी रोक न हो, तो उनके लिये उचित। केवल पीछे की तरफ मुँह करिय हुये स्थिति में तब तक प्रयोग करें जबतक शिशु का कन्धा कन्धे के चिह्न तक न पहुँच जाए (लगभग 12 महीने की आयु पर)।

शिशु के इस सीमा तक पहुँचने तक इस शिशु परतबिन्ध का प्रयोग जारी रखें।

शिशुओं को समय से पहले सामने की ओर बैठाने पर उन्हें गम्भीर चोट का खतरा होता है।

Conveniente para infantes de bajo peso y prematuros sin afecciones médicas que impongan restricciones. Debe utilizarse sólo orientado hacia adelante hasta que los hombros del niño alcancen el marcador de altura (aproximadamente a los 12 meses de edad).
Utilice este sistema de seguridad infantil hasta que el niño alcance ese límite.
El niño corre el riesgo de sufrir lesiones graves si se utiliza la silla orientada hacia adelante antes de tiempo.

適用於無特殊醫療狀況、體重較輕的嬰兒以及早產嬰兒。僅可後向安裝使用，直至嬰兒肩膀達到肩高標記（大約12個月大）。
孩子應一直採用後向式坐姿，直至其達到後向式坐姿的上限。
孩子若過早乘坐前向式汽車座椅，可能會對其造成嚴重的傷害。

Adatto per neonati prematuri o di basso peso di basso senza condizioni mediche limitanti. Da utilizzare solo in posizione rivolta all'indietro fino a quando le spalle del bambino raggiungono il marcatore di altezza (circa 12 mesi di età). Continuare a utilizzare questo sistema di ritenuta per neonati fino a quando il bambino raggiunge questo limite. I neonati sono a rischio di lesioni gravi se messi in posizione frontale troppo presto.

INTRODUCTION

The Infant Carrier and base is installed so that the infant is facing rearwards. This provides best position in a crash for infants.

This Infant Carrier provides the ability to fit low birth weight or premature babies and has been tested with a special dummy to verify its capability.

No child restraint can guarantee absolute protection from injury in every crash. However, to ensure that your child gets all the protection designed into the restraint, PLEASE READ AND FOLLOW THESE INSTRUCTIONS EXACTLY and use only Safe-n-Sound recommended parts and accessories.

Carefully read all the instructions for installation in this book. If in doubt about the method of installation, consult Britax childcare or agent or a child restraint fitter or, in New Zealand, to consult the agent for the vehicle.

If you have purchased this product with ISOFIX compatibility, the base is fitted with ISOFLEX™ connection straps on each side, with an ISOFIX compatible connector and tension indicators.

If fitted with the ISOFLEX™ connectors, the base may also be fitted to a centre position using the car's seatbelt.

The Infant Carrier is suitable for fitting to a variety of Britax, Steelcraft and BOB Strollers using one of the adaptor systems. For compatible Strollers refer to www.britax.com.au.

Britax Click & Go™ Adaptor is required for some strollers.

Britax Childcare Pty. Ltd. continues to provide care for your children when travelling in motor cars with a range of child restraints suitable throughout their childhood.

Regional Road Rules restrict the use of child restraints, like this Infant Carrier, in the front seat of the car. Check your local Road Rules.

Always store the instruction book in the place provided in the base when the Infant Carrier is removed.

INDEX

PAGE

- 10 WARNINGS AND IMPORTANT MESSAGES
- 13 SHOULDER HEIGHT MARKERS AND A GROWING CHILD
- 15 SHOULDER HEIGHT MARKERS AND THE NEXT STEP
- 16 SPECIAL FEATURES
- 19 SUITABLE FOR USE
- 21 USING THE INFANT CARRIER
- 25 INSTALLING THE BASE
- 27 HOW TO INSTALL THE BASE - WITH SEATBELT
- 29 HOW TO INSTALL - TOP TETHER STRAP
- 31 HOW TO INSTALL THE BASE - WITH ISOFLEX CONNECTORS
- 34 HOW TO REMOVE THE BASE - ISOFLEX CONNECTORS
- 35 INFANT CARRIER SETUP
- 41 HOW TO USE
- 48 HOW TO INSTALL IN AN AIRCRAFT
- 51 CARE & MAINTENANCE
- 56 ACCESSORIES
- 58 INSTALLATION OF CAR ANCHOR FITTING
- 63 ALTERNATIVE INSTALLATION IF SEATBELT LOOSENS
- 65 TRAVEL SYSTEM
- 66 TRAVEL SYSTEM - INTEGRAL LATCH
- 69 TRAVEL SYSTEM - BRITAX CLICK & GO™ ADAPTOR
- 76 IN CASE OF CRASH

WARNINGS

- Use the restraint exactly as shown in the instructions.
- Supervision of children is needed because they may be able to undo the buckles and adjusters.
- **DO NOT LEAVE CHILDREN UNATTENDED IN THE CAR.**
- Do not alter or modify this restraint.
- Repairs must only be done by the manufacturers or agent.
- Fit the restraint firmly to the car seat.
- Fit the harness firmly to the child.
- A loose restraint or harness is dangerous.
- **DO NOT USE A REAR-FACING CHILD RESTRAINT WHERE AN AIRBAG IS FITTED IN FRONT OF THE SEATING POSITION.** For other airbags, refer to the car owner's handbook for warnings and instructions.
- To ensure infant's back is evenly supported do not put more than one nappy on the baby and make sure the nappy is not thickly folded at the back.
- Do not allow the restraint to come into contact with polishes, oils, bleach and other chemicals.
- Destroy the restraint if it has been in a severe crash, even if no damage is visible.
- Do not harness an infant wrapped in a blanket or swaddled. Any blanket or wrap must only be placed over the harness and infant.
- Always secure the loose end of the top tether strap. Do not use the child restraint where this strap may fall into the seat back or off the side of the seat.
- **ALWAYS ATTACH HOOK AND REMOVE SLACK.**
- Make sure the Infant Carrier handle is latched properly every time you pick up the Infant Carrier.
- **DO NOT USE THIS RESTRAINT WITHOUT THE COVER.**

IMPORTANT :

- Do not use the child restraint facing forwards. Do not use excessively upright or reclined.
- The restraint should not be purchased or sold as a second hand item. It is recommended not to use child restraints older than 10 years as the protection in an accident may be reduced.
- This restraint must be used in conjunction with a lap or lap-sash seat belt.
- **THIS RESTRAINT IS NOT SUITABLE FOR USE WHERE THE TOP TETHER STRAP MAY FALL INTO A SPLIT IN THE SEAT BACK OR OFF THE SIDE OF THE SEAT.**
- **THIS RESTRAINT MUST BE ATTACHED TO A CHILD RESTRAINT UPPER ANCHORAGE POINT IN THE CAR. REFER TO CAR OWNER'S HANDBOOK FOR LOCATION OF UPPER ANCHORAGE POINTS. REFER TO A CHILD RESTRAINT FITTING STATION IF NO UPPER ANCHORAGE POINTS ARE IN THE MOTOR CAR.**
- Seatbelt extenders are not recommended to be used if the seatbelt is not long enough to secure the child restraint. If seatbelts are too short then seek advice from a child restraint fitter and consider their recommendations before using a seatbelt extender. If you use a seatbelt extender then ensure that the seatbelt buckle does not sit above the base moulding.

IMPORTANT :

IF THE BASE IS ONLY FOR INSTALLATION WITH SEATBELT:

- TO BE USED WITH LAP-SASH OR LAP ONLY SEATBELTS IN THE BACK OF MOST CARS WITH FORWARD FACING SEATS.
- Without ISOFIX compatible connectors; this child restraint is not approved for use with any connectors that connect to the car's ISOFIX low anchorages.

IF THE BASE IS FITTED WITH ISOFLEX CONNECTORS:

- TO BE USED WITH A LAP-SASH OR LAP-ONLY SEATBELT OR ISOFIX LOW ANCHORAGES IN THE BACK OF MOST CARS WITH FORWARD FACING SEATS.
- Do not attach the lower attachment connectors of two separate child restraints to the same ISOFIX low anchorages in your car.
- Always attach the top tether strap to the child restraint and upper anchorage in your car before each journey.
- Child restraint lower attachment connectors and the ISOFIX low anchorages in your car are designed to withstand only those loads imposed by a correctly fitted child restraint.

SHOULDER HEIGHT MARKERS AND A GROWING CHILD

NEW BABY

Shoulders below the Shoulder Height Marker.

Maximum Shoulder Height Marker

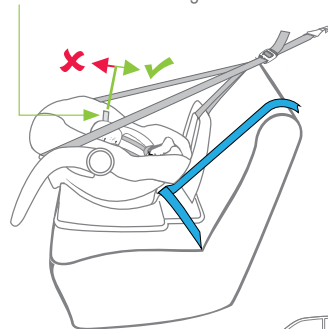

OLDER BABY

Shoulders in-line with the Shoulder Height Marker- then you will need to move to the next child restraint.

Maximum Shoulder Height Marker.

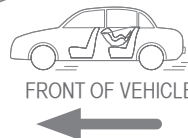
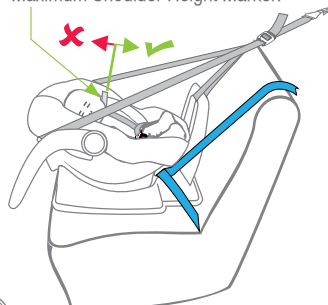

FRONT OF VEHICLE

The Infant Carrier is not suitable for your child when their shoulders are above the shoulder height marker.

If the baby's neck muscles are unable to support their head then the child should remain rear facing, choose a child restraint that will take larger babies in rear facing.

DO NOT MOVE TO THE NEXT RESTRAINT UNTIL SHOULDERS REACHES THE SHOULDER HEIGHT MARKER.

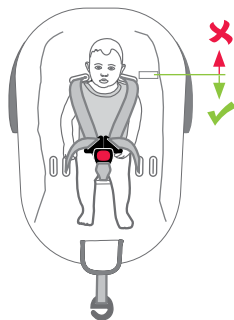

SHOULDER HEIGHT MARKERS AND A GROWING CHILD

Shoulder height markers are provided on this restraint for a visual indication that the child is safe to ride in this restraint.

! IMPORTANT: Follow this advice.

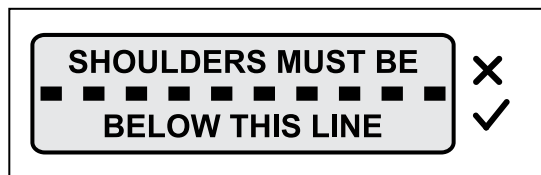

DO NOT MOVE TO THE NEXT RESTRAINT UNTIL THE BABY'S SHOULDER'S REACH THE SHOULDER HEIGHT MARKER.

When the baby's shoulders reach this marker, the child is now too big for the Infant Carrier. It is now time to move to the next child restraint, see next page.

SHOULDER HEIGHT MARKERS AND THE NEXT STEP

Next type of restraint that can be used in the car for your child.

When your child has outgrown the seat, you can then either use:

- Convertible Child Seat, If the convertible seat is suitable for approximately 12 months then continue to keep your child rear facing until they reach the shoulders reach the lowest marker. Then turn to forward facing until the child reaches the top marker - approximately 4 years of age. Some convertible child seats may allow option for the child to remain rearward facing until 2 to 3 years of age.



OR

- Dedicated forward facing seat with built-in harness- for children who have outgrown their infant carrier approximately 6 months, up to approximately 4 years of age, or 8 years of age depending on the restraint.

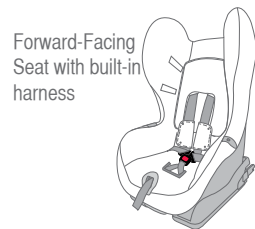

OR

- Convertible booster seat with in-built harness that faces forward- for children who have outgrown their rear facing seat approximately 6 months. This can be used up to approximately 4 years of age with built-in harness and then be converted to a booster seat and used up to approximately 8 years of age.



SPECIAL FEATURES

INFANT CARRIER

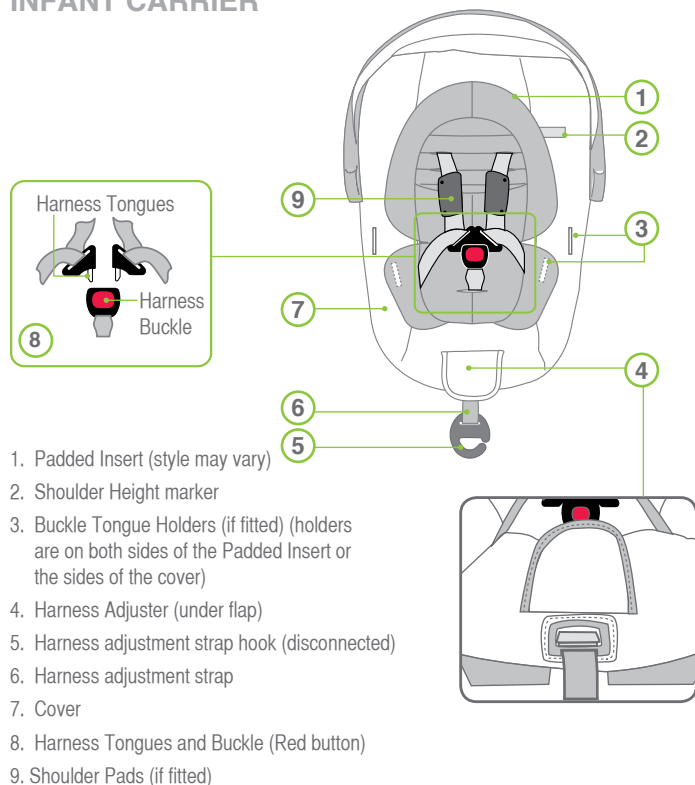

SPECIAL FEATURES

SEATBELT VERSION

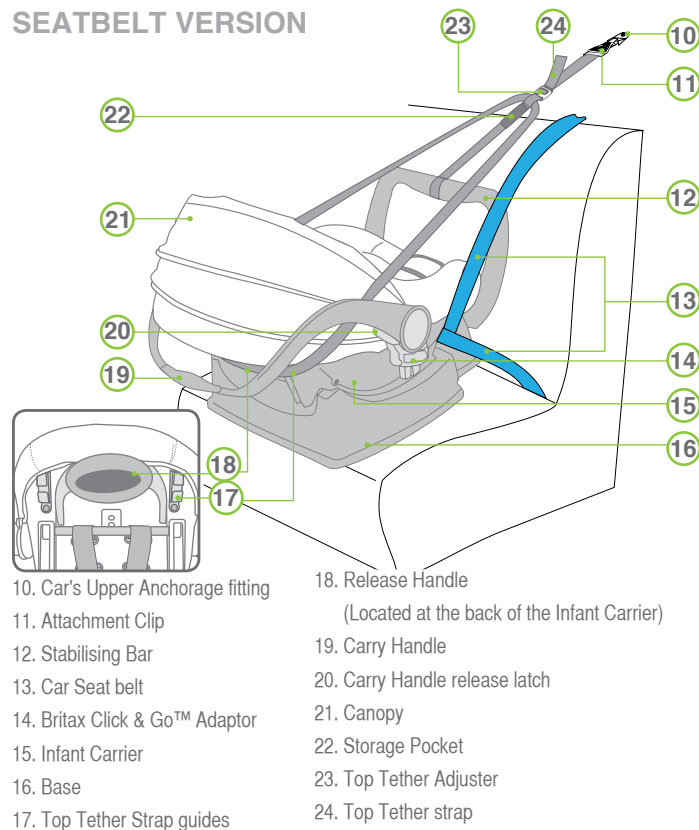

SPECIAL FEATURES

ISOFIX COMPATIBLE (WITH OPTIONAL ISOFLEX™ CONNECTORS)

ISOFLEX™ Connectors are flexible attachment connectors for use in a vehicle with ISOFIX low anchorages.

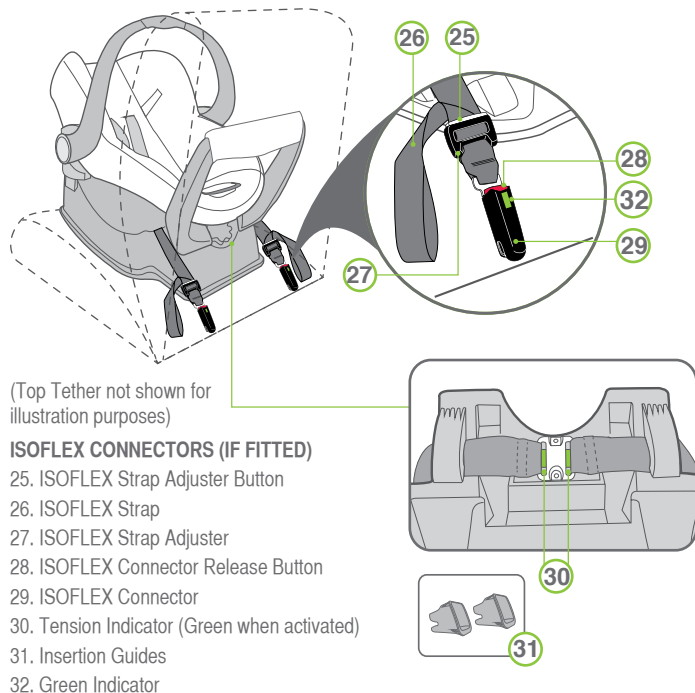

SUITABLE FOR USE

To be used only in a rearward-facing position for an infant until their shoulder's reach the shoulder height marker (approximately 12 months of age).

Continue to use this infant restraint until child reaches this limit.

Infants are at risk of serious injury if they face forward too early.

If the baby's neck muscles are unable to support their head, then the child should remain rear-facing, choose a restraint that will suit larger babies in a rear-facing mode.

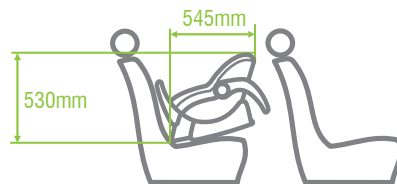

To ensure that the space is sufficient, the purchaser should check the measurements between the vehicle's rear and front seats in which the child restraint is intended to be used.

Ensure babies and toddlers are adequately shaded from direct sunlight through side or rear windows.

Check the car is ventilated by opening windows or using the car's ventilation system taking in external air. Recirculation setting is not suitable for providing ventilation.

SUITABLE FOR USE

WARNING

THE TETHER STRAP MUST ALWAYS BE FITTED WHEN THE CHILD RESTRAINT IS USED IN A VEHICLE.

Do not use the restraint without the top tether strap correctly attached.

The top tether strap must be attached to an anchorage point using an extension strap if necessary.

The Infant Carrier may just touch the front seat, but must not in such a way that the installation angle is affected.



Do not recline the seat excessively, it must be installed at the correct angle (see page 25 - 26).

Do not use on any vehicle seat which faces sideways or rearwards.

DO NOT USE A REAR-FACING CHILD RESTRAINT WHERE AN AIRBAG IS FITTED IN FRONT OF THE SEATING POSITION. For other airbags, refer to the car owner's handbook for warnings and instructions.

Seat belt extenders should not be used if the seat belt is not long enough to secure the child restraint. If seatbelts are too short the advice should be sought from a child restraint fitter and their recommendations considered before using a seatbelt extender. If they are used then the buckle must sit above the base moulding.

USING THE INFANT CARRIER

REMOVING INFANT CARRIER FROM BASE

A. Grasp the handle with one hand. With the other hand, lift the catch located at the front of the Infant Carrier.

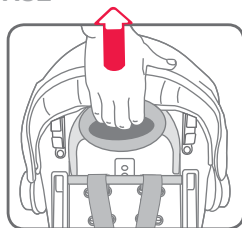

B. With the catch still lifted raise the Infant Carrier clear of the base.

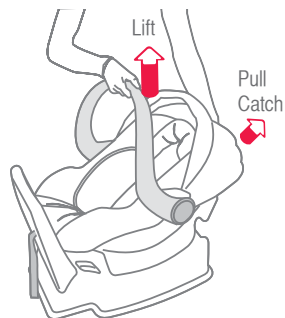

USING THE INFANT CARRIER

ADJUSTMENT OF HANDLE POSITION WITH BRITAX CLICK & GO™ ADAPTOR

- A. Squeeze the carry handle release latch on each side of the handle and rotate to the first position—"rocking position" ②.
- B. Squeeze the latch again and start to rotate the handle then remove both hands from the latches and use one hand at the top of the handle to rotate down further until the handle latches in the second or "non-rocking position" ③. The carrier is now locked to the stroller.

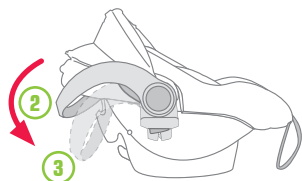
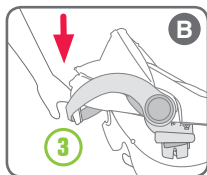
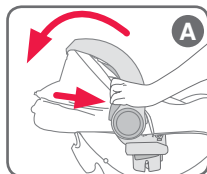

Push down until it clicks into place.



To avoid pinching your fingers follow the steps above.

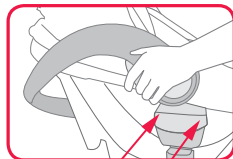

USING THE INFANT CARRIER

ADJUSTMENT OF HANDLE POSITION

The Unity™ Travel System Infant Carrier features a sturdy carry handle which can be used in conjunction with the curved base to convert it to a rocker. At the base of the handle there are two large buttons which control the three positions of the handle. These positions are the "carry (or travel) position" ①, the "rocking position" ②, and the "non-rocking position" ③.

- A. To convert from carry to "rocking position" ②, depress the large buttons on each side and rotate the handle towards the front of the Infant Carrier. When you have started rotating the handle release the buttons and continue rotating the handle round until it locks into position.
- B. Ensure the handle is locked in position securely. The "rocking position" ② enables the Infant Carrier to rock without the possibility of the Infant Carrier tipping over.
- C. To convert to a "non-rocking" ③ position depress both buttons and rotate the handle to the fixed position. Ensure the handle is locked in position securely.

① Carry Position



② Rocking Position

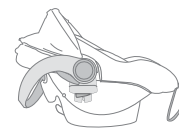

③ Non-rocking Position

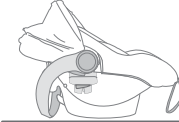

IMPORTANT :

Do not place the Infant Carrier on a table or a work-top where it could fall off.

USING THE INFANT CARRIER

TO FIT AND USE THE CANOPY

- With the viewing window flap on the outside, grasp the Canopy ensuring the two plastic frame sections at both sides are aligned.
- Push the two plastic frame sections at both sides onto the Infant Carrier at the inside of the handle pivot.
- Refit the elastic Canopy strap to the dedicated elastic trim strap on each side of the Infant Carrier.

NOTE: Elastic Canopy loops must always be fitted when Canopy is in use.

- The Canopy can be rotated to cover the baby or folded by rotating to the desired position.

TO REMOVE CANOPY

- Ensure Canopy is in the collapsed position. Unclip the elastic Canopy straps which are secured by plastic hooks under each handle attachment point.
- Grasp the Canopy and pull it away from the Infant Carrier ensuring the straps are clear of catching any objects.

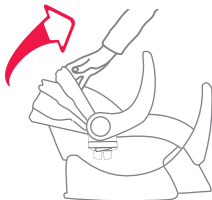
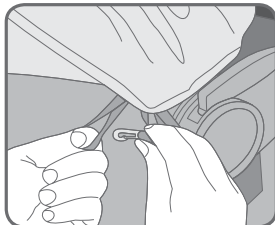
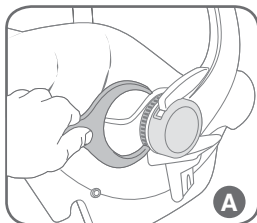

INSTALLING THE BASE

INSTALL INTO VEHICLE

Remove all packaging from the Infant Carrier. Remove the ISOFIT insertion guides (page 18, Ref 31) from the supplied location and store safely for further use.

Consult the car owner's handbook for location of top tether anchorage points.

If there is no child restraint anchor fitting or child restraint anchor point refer to pages 58 to 62 for the installation of the anchor fitting as well as the use of extension straps.

An anchor fitting is required to attach the top tether strap to fully install the Carrier to the car. The top tether strap must be used with this infant carrier when used in the car.

For installing the Base to the car, select a seating position with a child restraint anchor fitting directly behind the seating position.

ADJUSTING THE BASE ANGLE

- Place the base and Infant Carrier on vehicle seat in a seating position where a child restraint anchor fitting is installed. The Level Indicator Line needs to be level with the road, (i.e. parallel with the road surface). Check and adjust the Levelling knob of the base if necessary.

- If your car's seat is contoured then you may need to adjust the angle of the base so your baby is not too upright.

The angle may be altered by turning the base levelling knob located at the rebound bar end which will cause the levelling foot to extend from the under side of the base.

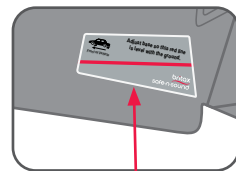

Level Indicator Line on both sides of base.

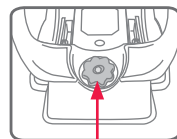

Levelling Knob

INSTALLING THE BASE

Always leave a rearward slope angle of approximately 10° to 15°

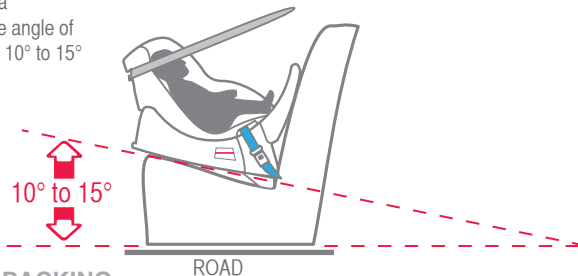

MANUAL PACKING

The angle may also be altered by placing a firm packing between the seat and the underside of the base (packing can be a firmly rolled up towel or nappy). For some vehicles with flat seats some packaging may be required at the front edge of the base to get some recline. The stabilising bar does not need to touch the car's seat back but should be close.

Always leave a rearward slope angle of approximately 10° to 15°

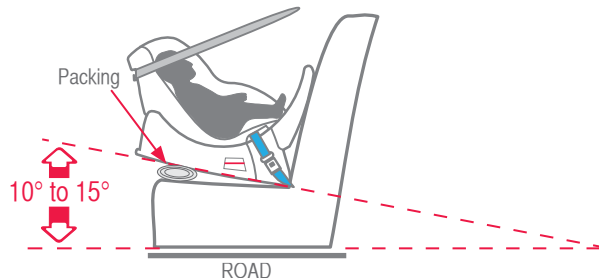

HOW TO INSTALL THE BASE - WITH SEATBELT

HOW TO INSTALL BASE USING LAP SASH SEATBELT

- A. Place the base into the car in the selected seating position with the Stabilising bar against the vehicles seat back as shown. Confirm the base angle as desired, otherwise adjust as shown on page 25 to 26.

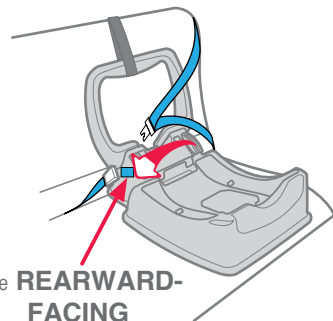

Blue **REARWARD-FACING BELT PATH** label

- B. Extend the seat belt to maximum length. For a lap-sash seat belt, position the tongue in the middle of the fully extended belt. Feed the seat belt through the blue REAR-FACING SEATBELT PATH labels on each side and under Belt Guide Hooks.

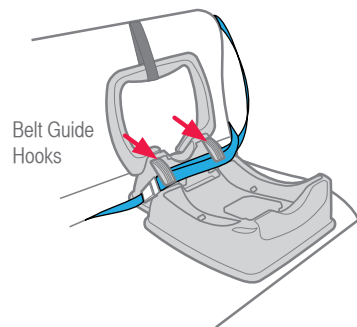

Belt Guide Hooks

HOW TO INSTALL THE BASE - WITH SEATBELT

- C. Engage the seat belt tongue to the buckle. Push downwards and rearward on the restraint base to compress it into the vehicle seat. Whilst compressed in the seat, pull on the lap belt to remove slack.

- D. If a lap-sash seat belt is used then allow the excess sash belt to feed back in to the retractor.

If the seat belt will not stay tight in every day use, then fit a gated 3-bar slide (not supplied with seat) to the lap-sash belt to prevent loosening. See pages 63 and 64. Ensure the 3-bar slide is removed when the Infant carrier base is not installed to allow other uses to use the seatbelt as a lap-sash seatbelt.

- E. Locate the child restraint upper anchorage fitting in the vehicle that is directly behind the rear seat location chosen. Refer to the car owner's manual for the location (If there is no upper anchorage fitting then refer to pages 58 to 62 for instructions in adding an anchor fitting).

- F. Connect the top tether strap attachment clip to the anchor fitting in the car as detailed on page 29. Install top tether strap to the Infant Carrier as shown on page 29.

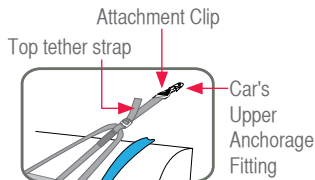
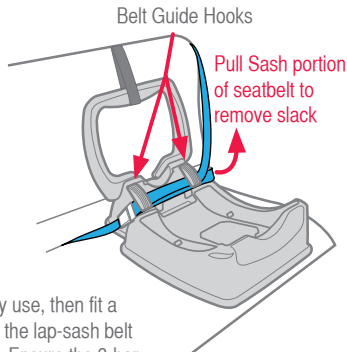

HOW TO INSTALL - TOP TETHER STRAP

Once the carrier is fitted to the base, refer to page 45.

- A. Lengthen the strap fully by pressing the adjuster button (1) and pull the strap (2) so that the strap is ready to attach to the Carrier.

THIS TOP TETHER STRAP MUST ALWAYS BE FITTED WHEN THE INFANT CARRIER IS USED IN THE CAR.

- B. Feed the Top tether strap on the inside of the handle, around the front of the carrier and through the Top Tether Strap guides in the front of the Infant Carrier.

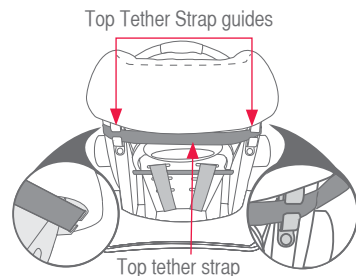

- C. Adjust the top tether strap by pulling (3) as shown in Fig. 1 to remove all slack in the straps. Do not over tighten.

- D. Roll up excess strap and place into the storage pocket attached to the top tether.

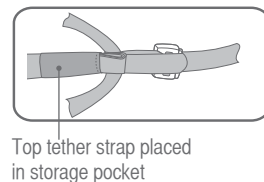
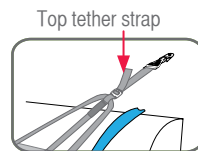
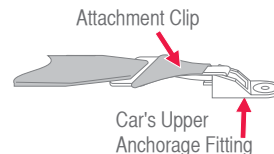
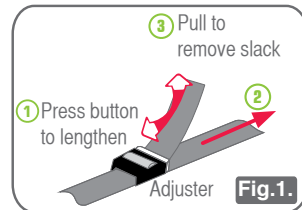

HOW TO INSTALL - TOP TETHER STRAP

! IMPORTANT :

The Top tether strap must be fitted at all times when the baby is in the car when using either the seatbelt or the ISOFLEX connectors.

Always secure the loose end of the top tether strap to prevent it hanging out of the car or being accessible by the child.

THIS RESTRAINT IS NOT SUITABLE FOR USE WHERE THE TOP TETHER STRAP MAY FALL INTO A SPLIT IN THE SEAT BACK OR OFF THE SIDE OF THE SEAT.

Always ensure that the car seatbelt and top tether strap are firmly restraining the restraint on the vehicle seat.

ALWAYS ATTACH TOP TETHER HOOK AND REMOVE SLACK IN THE TOP TETHER STRAP.

! CAUTION:

CHILDREN CAN BE INJURED OR RESTRAINTS AND TOP TETHER STRAP DAMAGED BY UNSECURED CARGO IN A COLLISION. SECURE OR REMOVE HAZARDOUS CARGO BEFORE USING THIS CHILD RESTRAINT.

REMOVING THE BASE FROM THE CAR

When removing the base, release the attachment clip from the car's upper anchor fitting then remove the seatbelt or remove ISOFLEX low anchorages.

HOW TO INSTALL THE BASE - WITH ISOFLEX™ CONNECTORS

WHAT ARE ISOFIX LOW ANCHORAGES IN A VEHICLE?

ISOFIX low anchorages are fixed, standardised anchoring points for securely installing an ISOFIX compatible child restraint in a vehicle with ISOFIX low anchorages. It has now become an international standard for vehicles. This anchoring technology minimises installation mistakes by optimising the protective effect of a solid connection between vehicle and ISOFIX compatible child restraint.

INSTALLING THE BASE INTO THE CAR (USING ISOFLEX CONNECTORS IF FITTED)

To prevent damage to vehicle seat it may be necessary to remove or open a trim covering the ISOFIX low anchorages.

- Locate the ISOFIX Low Anchorages in the vehicle seat bight. The location may be identified by one of the following symbols, or the anchorage bars may be visible.



ISOFIX low anchors in the vehicle seat

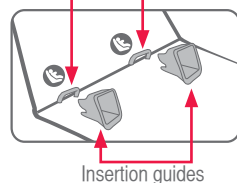

If you cannot locate them, check your vehicle owners manual.

- If necessary, clip the two insertion guides to the two ISOFIX fastening points of the vehicle seat (between seat and backrest). Tab must be upwards. Allow the guides to rise so they hook on to the ISOFIX low anchor bars. The guides are provided to allow easier alignment of the child restraint. The guides are not required where anchors are visible or there are already guides provided in the vehicle seat.

HOW TO INSTALL THE BASE - WITH ISOFLEX™ CONNECTORS

- C. Remove ISOFLEX connectors from the stored location underneath the base by pressing the red button to release them.

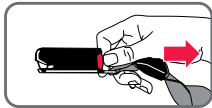
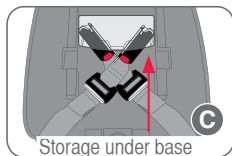

- D. Press and hold the adjuster release button and pull the connectors strap to fully lengthen it. Repeat for both connector straps.

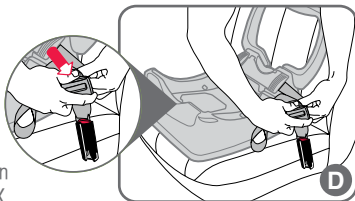

- E. Place the Base in the desired location on the vehicle seat between the two ISOFIX low anchorages with the stabilising bar against the vehicle's seat back as shown. Engage the ISOFLEX connectors in to each ISOFIX low anchorage. A click may be felt or a green indicator will show on the top of the ISOFLEX connector when it has engaged. Pull each strap to ensure both lower anchorage connectors are engaged.

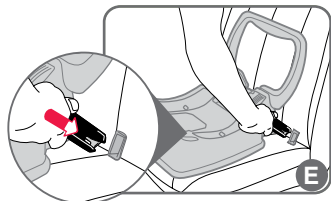

- F. Confirm the base angle as desired, otherwise adjust as shown on page 25 to 26 how to setup base.

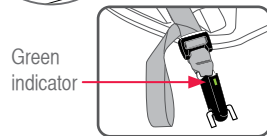

HOW TO INSTALL THE BASE - WITH ISOFLEX™ CONNECTORS

- G. Feed the ISOFLEX connector straps under the belt guide hooks as shown on Fig.2. Ensure the straps are not twisted.

- H. Push downwards and rearward on the restraint base to compress it into the vehicle seat. Whilst compressed into the seat, pull on adjuster strap to remove all slack and tighten the strap. Repeat for the adjuster strap on the other side of the base. The two tension indicators will show green indicating adequate tension has been applied.

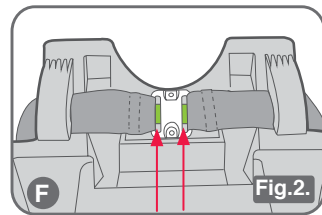

Tension indicators
Green when tensioned



IMPORTANT:

Do not attach the lower attachment connectors of two separate child restraints to the same ISOFIX low anchorages in your car.

Always attach the top tether strap to the child restraint upper anchorage in your car.

Child restraint lower attachment connectors and the ISOFIX low anchorages in your car are designed to withstand only those loads imposed by a correctly fitted child restraint.

- I. Locate the child restraint upper anchorage fitting in the vehicle that is directly behind the rear seat location chosen. Refer to the car owner's manual for the location (If there is no upper anchorage fitting then refer to pages 58 to 62 for instructions in adding an anchor fitting).
- J. Connect the top tether strap attachment clip to the anchor fitting in the car as detailed on page 29. Install top tether strap to the Infant Carrier as shown on page 29.

HOW TO REMOVE THE BASE - WITH ISOFLEX™ CONNECTORS

REMOVE THE BASE

A. Press each of the red release button on the ISOFLEX connectors and remove them from the ISOFLEX low anchorages.

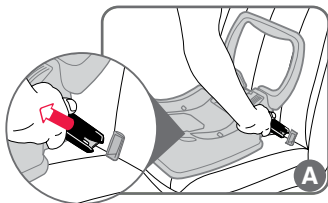

B. Adjust connector strap to allow the connector to engage the storage bars on the base underside. Wrap the strap as shown by crossing them on the underside. Remove the slack but do not tighten. The tension indicators should not turn green.

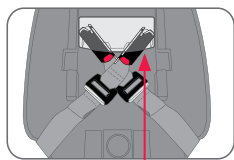

Storage under base

Press adjuster and lengthen ISOFLEX strap to required length for storage.

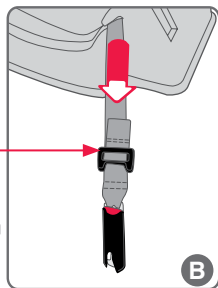

NOTE: The insertion guides should be removed when not in use and kept in a safe place. In vehicles with folding down backrests, the insertion guides must be removed before folding down the backrest.

INFANT CARRIER SETUP

HARNESS FEATURES

1. Outer crotch strap slot
2. Middle crotch strap slot
3. Low birth weight infant crotch strap slot
4. Outer lap strap slot
5. Low birth weight infant lap strap slot
6. Harness tongues & buckle
7. Shoulder harness strap
8. Low birth weight infant shoulder strap slots
9. Lower shoulder strap slots
10. Medium shoulder strap slots
11. Upper shoulder strap slots
12. Maximum shoulder height marker.
13. Harness Adjuster (under cover flap)

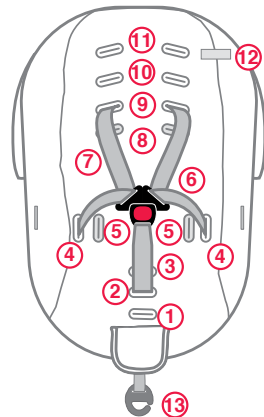

FOR LOW BIRTH WEIGHT BABIES

The Infant Carrier is supplied with harness setup to suit an average birth weight, new born infant (approx 3.4kg). However, if your child is low birth weight or premature then you may need to reposition the harness to the "smaller infant" position, as follows:

Move the crotch strap to the inner slot (3) (see page 37) the lap straps to the inner slots (5) (see page 36) and the shoulder strap to the inner slot (8) see page 38. This will provide better support for smaller babies.

If the infant is newborn and over 3kg, generally you will need to use either slot (9) or (10) and crotch strap position (2). Assess the harness fitment and adjust as necessary by following Setting Up The Harness, see page 39.

For low birth weight or premature babies with breathing difficulties or medical concerns, we recommend you seek medical advice before travelling.

INFANT CARRIER SETUP

LAP STRAP

The Infant Carrier is fitted with two lap strap positions. Correct location of lap strap will assist to correctly and securely position the infant in Infant Carrier.

The Infant Carrier comes supplied with the lap straps for an average birth weight baby (out lap slots).

NOTE: As a low birth weight baby grows the lap strap will need to be moved to the outer slot.

ADJUSTMENT OF LAP STRAP

Remove infant from the infant carrier prior to making adjustments.

- Remove the Infant Carrier from base as instructed on page 21.
- Lift Infant Carrier cover to reveal lap strap slot.
- From the top side of Infant Carrier turn the crotch 3-bar slide and push through each slot as shown right until the lap strap assembly is free from the Infant Carrier.
- Re-insert lap strap through the slot which will position lap strap level with the baby's thighs and feed back through other slot as shown right.

LOW BIRTH WEIGHT LAP STRAP

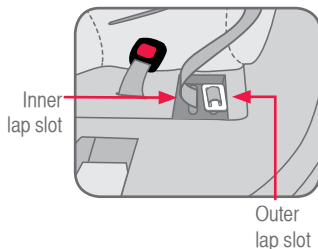

AVERAGE BIRTH WEIGHT LAP STRAP

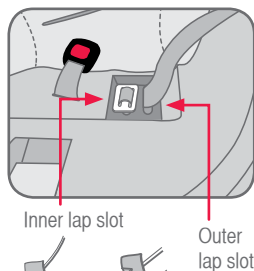

IMPORTANT :

When replacing straps, cover and padded insert, ensure none of the straps are twisted and that all straps are secure by pulling each harness strap.

INFANT CARRIER SETUP

CROTCH STRAP

The Infant Carrier is fitted with three crotch strap positions. Correct location of crotch strap will assist to correctly and securely position the infant in Infant Carrier and will help prevent infant from slipping further down the Infant Carrier or slumping.

NOTE: The low birth weight position is shorter than other positions. This method can be used to position the buckle lower on the baby.

As baby grows the crotch strap must be moved to the outer slot.

ADJUSTMENT OF CROTCH STRAP

Remove infant from the infant carrier prior to making adjustments.

- Remove the Infant Carrier from base as instructed on page 21.
- Lift Infant Carrier cover to reveal crotch strap slot.
- From the top side of Infant Carrier turn the crotch 3-bar slide and push it through each slot as shown right until the Crotch strap assembly is free from the Infant Carrier.
- Locate desired slot in shell, cover and padded insert (if fitted)
- Insert Crotch strap through desired slot and feed back through other slot as shown right.
- Ensure crotch strap is not twisted and positions the red button outwards.

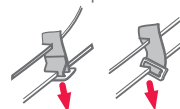

LOW BIRTH WEIGHT CROTCH STRAP

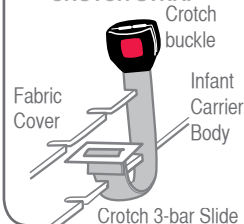

AVERAGE BIRTH WEIGHT CROTCH STRAP

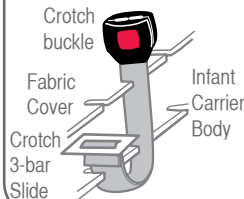

LARGER BABY CROTCH STRAP

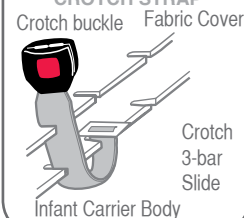

INFANT CARRIER SETUP

ADJUSTING THE SHOULDER STRAPS

Remove infant from the infant carrier prior to making adjustments.

- At the rear of the Infant Carrier, remove one of the harness shoulder straps from metal strap connector by slipping strap through open slot. The metal strap connector is shown in diagram right.
- Pull the shoulder strap through slot to the front of the Infant Carrier, through all the trims.
- Pass shoulder strap back through desired slot in padded insert cover and corresponding slot in the shell. The slot **MUST** position the shoulder strap level with or the next slot above the baby's shoulder. If a Padded Insert is used, that will need to be re-positioned and the strap re-inserted when changing the slot position.
- Refit the shoulder strap to the metal strap connector. Ensure webbing is installed correctly over the bar. Repeat straps A,B and C for the other strap. Ensure both shoulder straps use the same height slot pairs.

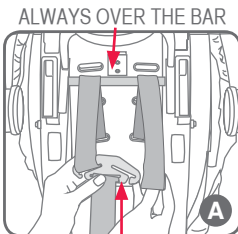

Metal Strap Connector

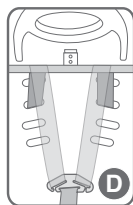
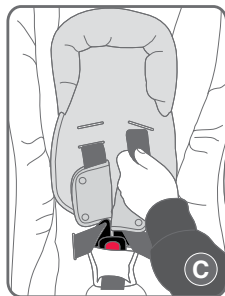

IMPORTANT :

When replacing straps, cover and padded insert, ensure none of the straps are twisted and that all straps are secure by pulling each harness strap.

INFANT CARRIER SETUP

SETTING UP THE HARNESS

This section covers the setting up of the harness to fit the infant. Fitting the harness is not required. Securing of the infant is covered later in the instructions.

The Infant Carrier is fitted with four shoulder strap positions. As the baby grows the shoulder straps must be moved to higher slots.

- Sit the Infant Carrier on flat ground with the handle rotated fully back to prevent rocking.
- Lengthen the harness straps by pressing the harness adjuster (under the flap) and pulling both shoulder harness straps evenly. Release the buckle.
- Move the two harness tongues to the sides of the infant carrier and store in the buckle tongue holder (if fitted) (holders are on both sides of the padded insert or the sides of the cover). Move the harness buckle towards the harness adjuster.
- Place baby into infant carrier lying on its back so that the buckle is between the legs.
- Determine which Infant Carrier straps require adjustment to fit the harness correctly. Confirm crotch strap adjustment first, followed by lap strap and finally shoulder straps. Adjust as required following the instructions:

Lap Strap - page 36

Crotch Strap - page 37

Shoulder Strap - page 38

Always remove baby from Infant Carrier prior to making adjustments.

Press the harness adjuster and pull the harness straps to slacken.

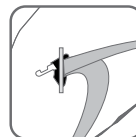
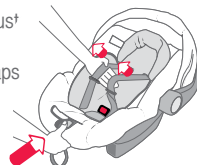

Buckle Tongue Holder (if fitted)

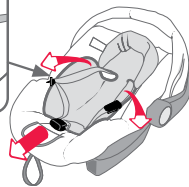

INFANT CARRIER SETUP

E. The Infant Carrier is fitted with four shoulder strap positions. As the baby grows, the shoulder straps must be moved to higher slots.

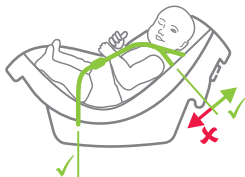

F. It is better to change one strap at a time so that the other strap will be a guide for re-assembly.

The shoulder straps must be in the slots which are nearest to the child's shoulders, but not lower than the child's shoulders.

LOW BIRTH WEIGHT INFANT

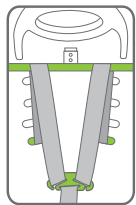

AVERAGE SIZE BABY

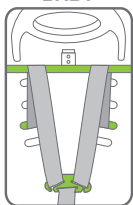

GROWING BABY

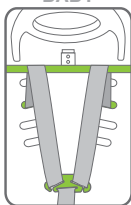

LARGER BABY

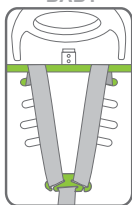

! IMPORTANT :

- Always adjust the height of the shoulder straps as the child grows
- Do not use the carrier with the harness shoulder straps set at different heights or fed through mismatching slots.
- Ensure the harness straps are not twisted and that all straps are secured by pulling each harness strap.
- Only fit the straps over the bar otherwise the harness will not tighten.

HOW TO USE

PLACING INFANT IN CARRIER

If your child is of low birth weight or less than 3kg then you will probably need to use the harness arrangement for low birth weight babies. Refer to page 35.

When positioning baby into Infant Carrier make sure baby's back is fully supported onto the flat section and the baby's nappy area (bottom) is resting in the bottom curvature as shown. It is recommended that bulky nappies are not used when baby is travelling in the Infant Carrier as they can cause incorrect positioning of the baby's back in the Infant Carrier.

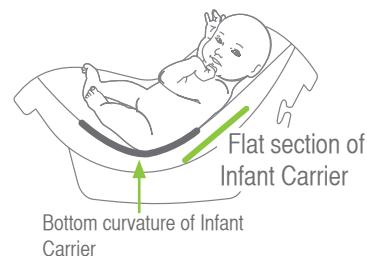

A. Loosen shoulder straps by pressing the harness adjuster and pull both shoulder straps evenly. Pull out the desired amount of slack.

Press the harness adjuster and pull both harness straps evenly to loosen.

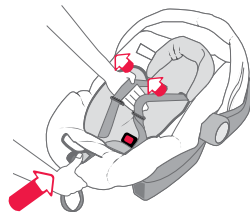

HOW TO USE

- B. Place the two harness tongues into the Buckle Tongue Holder (if fitted).

Move the harness buckle towards the harness adjuster for easier fitment next time you put the infant in the carrier.

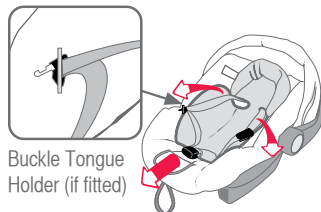

- C. Place baby into Infant Carrier lying on its back so that the buckle is between the baby's legs. Ensure that baby's arms and legs are free. Make sure baby is dressed to allow the Harness Buckle to be pulled up between baby's legs e.g. a jump suit.



NOTE:

1. Discontinue using the Padded Insert when shoulder straps are in the top slots or if the Pad causes over heating, discomfort or you need more room for baby to grow.
2. Correct fitment of the harness is very important as it restrains the baby in the Infant Carrier. The harness must fit firmly around upper torso of the baby and be positioned so as to leave the baby's arms and legs free.



CAUTION:

Do not harness an infant wrapped in a blanket or swaddled as this increases the risk of ejection and injury or death in a crash. The harness needs to fit firmly to the baby, any blanket or other covering may be placed over the harness after the harness is adjusted. Arms and legs must be free and not bound. The legs must sit on each side of the crotch strap.

HOW TO USE

- D. Place each arm through each shoulder strap of the harness. Position the buckle of the crotch strap as shown right.



- E. Fit either harness buckle tongues into the harness buckle followed by the other tongue. A click is heard when the last tongue is fully engaged.

Should the second tongue not insert - press the red button and reinsert the tongues. Ensure secure engagement by pulling harness straps. If the harness buckle does not engage correctly then it may require cleaning or need replacement - refer to page 52. **The buckle tongues are fully engaged when both tongues are inserted and 'click' is heard.**

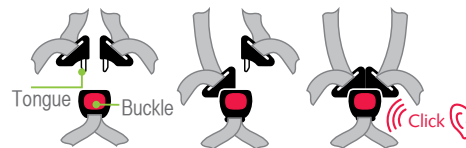

HOW TO USE

- C. Ensure slack is removed from the lap straps by pulling the shoulder harness straps through the buckle tongues, then pull the Harness Adjustment Strap to take up the slack in the harness, adjusting to a firm but comfortable fit. Make sure that the baby's arms and legs are free and the crotch strap is between the legs. Check that the slack in straps is minimal.

Do not use the restraint if straps do not tighten and contact Customer Service.

Pull Harness Straps through the buckle in direction of arrows

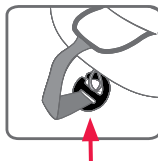

Pull harness adjustment strap to remove slack.

Hook the harness adjuster strap on to the loop to prevent tripping over the strap.

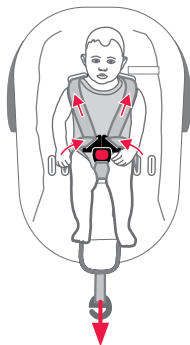

! CAUTION:

The end of the harness adjustment strap is connected to the cover to avoid tripping over the end when carrying the Carrier. Ensure the harness adjustment strap hook is attached when carrying the carrier.

! WARNING: DO NOT LEAVE CHILDREN UNATTENDED IN THE CAR.

! CAUTION: A LOOSE HARNESS IS DANGEROUS

HOW TO USE

PLACING BABY & INFANT CARRIER ONTO BASE

- A. Position the Infant Carrier over the top of the base. Make sure the Harness Adjustment Strap is not caught between Infant Carrier and Base then lower the Infant Carrier into position.
- B. Push down on the Infant Carrier until an audible click is heard. Pull upwards on the Infant Carrier to check it is correctly locked into position.

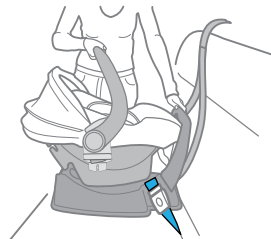

! IMPORTANT: Lift again to check engagement.

- C. Attach the top tether around the infant carrier by feeding through the handle and onto the top tether strap guides as shown.

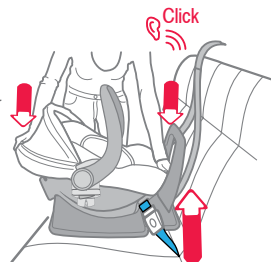
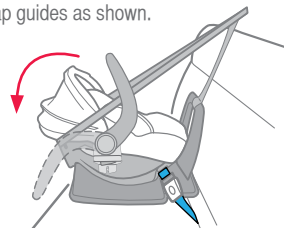

Top Tether Strap guides

- D. The handle may be rotated into other positions if needed although this may be difficult due to the front seating position.
- E. Always secure the loose end of the top tether strap in the pocket on the top tether strap to prevent it hanging out of the car or being accessible by the child.

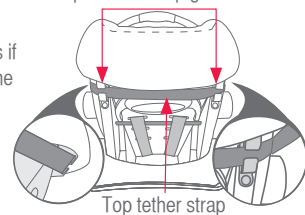

HOW TO USE

REMOVING BABY & INFANT CARRIER FROM BASE

- Loosen the top tether strap. Ensure that the adjuster does not fall on the baby.
- Remove the top tether strap from the tether strap guides on the Infant Carrier.
- Place top tether strap between the stabilising bar and the car seat back so that it will not fall behind the seat or get trapped in the door. This will keep the top tether strap visible and ready for use when the Infant Carrier is put back in the car.
- Rotate the Carry Handle to the "carry position" as shown.
- Grasp the handle with one hand then pull the Infant Carrier release catch with the other hand. With the catch lifted raise the Infant Carrier clear of the base.

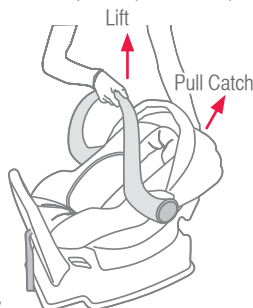

Always ensure the handle is locked in position before lifting.

- When the Infant Carrier is clear of the base, carefully remove it from the car.

Ensure the harness adjustment strap hook is connected to the loop.



CAUTION:

The end of the harness adjustment strap is connected to the cover to avoid tripping over the end when carrying the Carrier. Ensure the harness adjustment strap hook is attached when carrying the carrier.

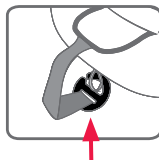

Hook the harness adjuster strap on to the loop to prevent tripping over the strap.

HOW TO USE

REMOVING BABY FROM INFANT CARRIER

- Rotate the carry handle to the "non-rocking position" and ensure the Canopy is fully open.
- Press the Harness Adjuster while pulling both shoulder straps evenly to loosen the harness.
- Press the red button on Harness Buckle to release both harness tongues. Place buckle tongues through buckle tongue holder's (if fitted) on each side of the cover or padded insert otherwise place straps on each side of the carrier clear of the infant.
- Feed the infants's arms through each side of the harness. Lift the baby out of the carrier.

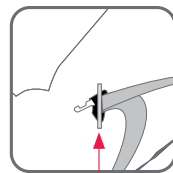

Buckle Tongue Holder (if fitted)

NOTE: Once the baby gets heavier you may wish to leave the carrier in the car. In this case you will need to disconnect or loosen the top tether strap before removing the baby.

HOW TO INSTALL IN AN AIRCRAFT

HOW TO INSTALL USING AIRCRAFT LAP BELT

The Infant Carrier without base is suitable for use on aircraft.

The Infant Carrier must be used in accordance with the aircraft operators procedures, and any directions from the aircraft operator, pilot or crew.

The Infant Carrier may not fit in smaller aircraft.

Inform the aircraft operator that a child restraint is intended to be used on the aircraft when booking the flight as the child restraint may not be suitable for use in that operator's specific aircraft.

Follow the instructions of the flight crew or pilot.

For use of the child restraint in cars in countries other than Australia and New Zealand, The user should consult the country's local authorities, car hire companies, car insurance companies, etc. for advice. The child restraint may not be acceptable for use in all cars.

FIT THE INFANT CARRIER TO THE AIRCRAFT SEAT

You do not need the base and we recommend that you check it in with your luggage.

A. Position the infant carrier rearward facing, align it centrally within the allocated seating position. If possible, lift the armrests out of the way to improve access to installing the aircraft lap belt and to suit the width of the carrier.

B. Carefully remove cover on the side to reveal **AIRCRAFT REARWARD-FACING BELT PATH** label marked in green.

AIRCRAFT REARWARD-FACING BELT PATH marked in green.

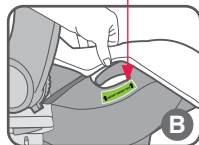

NOTE: Never use this path in a car

HOW TO INSTALL IN AN AIRCRAFT

C. Place handle in "non-rocking" position, that is, fully backwards. Fully lengthen lap belt. Thread the lap belt into **AIRCRAFT REARWARD-FACING BELT**

PATH lap belt path (green marker) as shown, ensuring that lap part is below the hook as shown, on each side. Engage lap belt buckle and tongue.

D. Push down on the infant carrier and remove all slack from the lap belt. Pull belt strap to tighten, ensure a firm fit of the infant carrier to the seat.

Do not use this restraint with aircraft seatbelt that contain airbags. The aircraft operator may replace them.

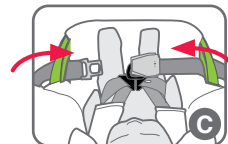
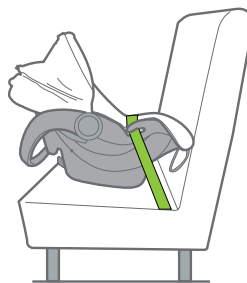

Ensure lap belt is under the hook on each side

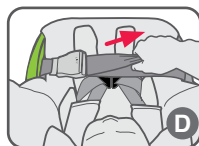
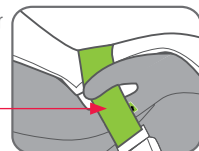

Remove slack

HOW TO INSTALL IN AN AIRCRAFT

The infant carrier base may be included with 'checked in' luggage (for use after flight). Aircraft label is located on the underneath of the infant carrier. It demonstrates suitability for use on aircraft.



This Child Restraint System meets the standards for use in aircraft as recommended by the Civil Aviation Safety Authority of Australia and the Civil Aviation Authority of New Zealand.

Only to be used on aircraft with the permission of the aircraft operator, pilot and crew.

SUITABLE FOR REAR FACING USE

The top tether strap is not required to be used onboard aircraft and should be stowed securely.

CARE & MAINTENANCE

REGULAR CARE OF THIS RESTRAINT:

Please check the following items regularly to ensure the safety of your child:

- Check the webbing straps for fraying,
- Check there are no cracks in moulding,
- Check the harness adjuster is operating and is clamping the webbing,
- Ensure the buckle is free of fluff, liquid or other matter that may enter the buckle slots. Clean the buckle if it is sluggish to engage. See next page.
- If any part of the restraint is cracked, broken or not operating seek repair immediately - contact Britax Customer Service 1300 303 330

CLEANING CAR SEAT

Use only mild soap and water to clean all metal and plastic parts of the restraint. Do not use chemicals or cleaning agents.

HARDWARE: Use only mild soap and water to clean all webbing, metal and plastic parts of your child's restraint, using a damp cloth.

Do not use chemicals or cleaning agents. Do not try and place any hardware into a washing machine.

STRAPS AND HARNESS: We only recommend that you spot clean the straps/harness with a damp sponge. The harness straps can be soaked, however they must be thoroughly dried without excessive heat (never tumble dry). The harness straps should not be placed in a washing machine as this may cause damage to the stitching or even damage your washing machine.

COVER: The restraint has a flame retardant cover which is removable for cleaning, please clip the hook and loop together on the cover and seat pad (if supplied) to prevent any damage to the cover when washing. Cleaning instructions are on the care label attached to the cover. For machine washable covers, use gentle cycle, cold water only, rinse well and dry on a flat surface. Do not tumble dry, do not bleach or dry-clean. May be hand washed. Follow the care label on the cover.

CARE & MAINTENANCE

BUCKLE OPERATION

To ensure the buckle remains operational the inside of the buckle must be kept free of liquids, sand, dirt, fluff, food or similar substances. If the buckle is not operating or you do not hear a strong audible click when second tongue is inserted then the buckle needs to be washed or replaced. The buckle is fully engaged when both tongues are inserted. Contact Customer Service for assistance.

TO CLEAN HARNESS BUCKLE:

If sticky liquids such as baby formula, fruit juice, etc. get inside your harness buckle, it may become sluggish. An indication of a sluggish harness buckle is that you cannot hear a click when engaging the last harness tongues. To restore the harness buckle to good working order it needs to be cleaned as follows:

- Remove the harness buckle from the restraint: From the underside of the restraint pull each crotch strap 3-bar slide, turn the 3-bar slide on its side and push back through the slot.
- Place the harness buckle under warm (max. 40 degrees Celsius) running water as shown below. Let the water run through the mouth of the buckle for five minutes. Check the harness buckle is clean by engaging the harness tongues and buckle several times until you hear a click.
- If you still cannot hear a strong audible click then repeat the cleaning process several times.
- Refit the harness buckle to the restraint ensuring the red button facing outwards and the 3-bar slide is fed through the same slots.

If the Harness Buckle cannot be returned to its original working condition then contact BRITAX Customer Service for assistance.

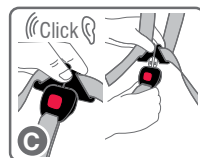
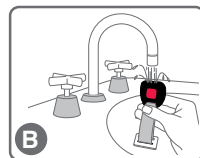
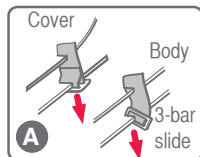

CARE & MAINTENANCE

COVER (STYLE MAY VARY)

The restraint has a flame retardant cover which is removable for cleaning. Cleaning instructions are on the care label attached to the cover. If fluffy cover is fitted then washing the cover prior to use will remove excess fluff.

The cover has been designed to protect your child when seated in the restraint. Care should be taken if children either eat or drink while in the restraint as some food or drink products may cause damage or marking to the cover. Wash or clean immediately. Do not pull sticky items from covers as the cover may be damaged - soak in water and gently remove.



VERY IMPORTANT:

Only replace the cover with Safe-n-Sound supplied replacement cover with identical shoulder height markers or a replacement cover meeting AS/NZS 8005.

ONLY USE BRITAX SAFE-N-SOUND SEAT COVERS AND ACCESSORIES THAT ARE DESIGNED AND TESTED FOR USE WITH THIS PRODUCT.

CARE & MAINTENANCE

TO REMOVE THE COVER

- Remove the Canopy (see page 24) and Baby insert pad (if supplied) as described on page 38. Unclip the two infant carrier cover straps which are secured by plastic hooks under the handle attachment point.
- Disconnect the shoulder harness straps from the Metal Strap Connector and feed through shoulder slots in both infant carrier and cover. Refer to page 38.
- Feed the shoulder harness straps and tongues through lap strap slots in the Cover only. There is no need to remove the harness straps from the Infant Carrier.
- Lift the cover around the rim of the infant carrier at the harness adjuster end, feed the crotch buckle through the slot in cover and pull the harness adjuster strap out of the slots.
- Remove the cover for cleaning.

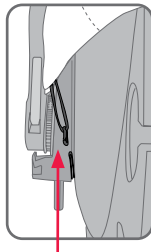

Unhook clips on either side of cover under the handle then remove cover

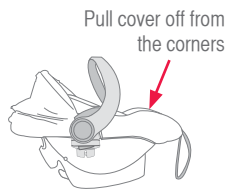

Pull cover off from the corners

CARE & MAINTENANCE

TO REPLACE THE COVER

- Place the cover over the infant carrier ensuring all slots in cover line up with slots in infant carrier.
- Ensure that there are no twists in all straps underneath the Infant Carrier.
- Feed the shoulder harness straps through lap strap slots in cover.
- Feed the shoulder harness straps through the shoulder strap slots in cover and then in through the Infant Carrier. **You MUST thread the shoulder strap OVER cross bar** and then re-attach the straps to metal strap connector at the back of the seat. Refer to page 39 to 40 for harness setup for your baby. Attach the shoulder harness straps to the strap connector.
- Feed the crotch buckle as well as the harness adjuster strap through the slots in the cover.
- Refit plastic hook on each side of the cover to Infant Carrier as shown right.
- Engage shoulder harness tongues and crotch buckle. Pull to check harness is attached.
- Ensure the straps are not twisted.**

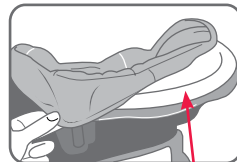

Pull elastic cover over Infant Carrier

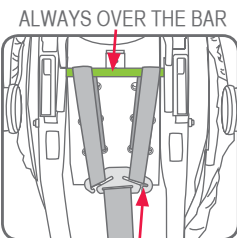

Metal Strap Connector

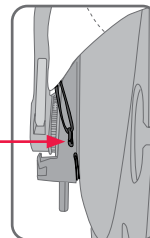

Plastic Hooks

ACCESSORIES

Use of aftermarket accessories, that is, accessories not provided with this child restraint can reduce the safety of the child restraint and may cause injury or death. Always follow the instructions covering the use of accessories in this section or the instructions provided with accessory. If an aftermarket accessory is used that is not recommended by Britax then ensure that the accessory is for this restraint compliant with AS/NZS 8005 and stated as suitable for use with this child restraint.

The following instructions apply to accessories that may be supplied with this restraint at point of purchase. If not, a variety of Safe-n-Sound accessories are available from various retailers of Safe-n-Sound products.

PADDED INSERT - Style may vary

The Padded insert is only required for supporting the smaller baby and must be removed once baby's shoulders reach the upper shoulder height marker to allow longer use of the Carrier.

- Disengage the harness buckle and feed the buckle out through buckle slot in the padded insert.
- Remove the insert pad by removing the shoulder harness straps from the metal strap connector and feeding the shoulder harness through the slots. See page 38.
- Discontinue using the Padded Insert when shoulder straps are in the top slots or if the Pad causes over heating, discomfort or you need more room for baby to grow.

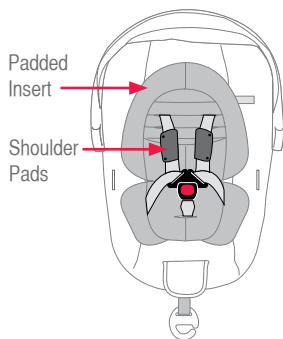

ACCESSORIES

HEAD PILLOW - Style may vary

The head pillow is only required for supporting the smaller baby and can no longer be used once the harness shoulder straps are in the top pair of slots. The pillow is fitted to the carrier by ties on the back of the pillow being threaded through the next pair of slots above the harness shoulder strap. Ensure the ties are threaded through slots in the backrest of the main moulding and tied together.

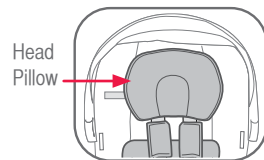

CANOPY

Refer to page 24.

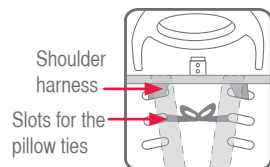

SHOULDER PADS - Style may vary

The shoulder pads may require release by press studs. If fully fitted to the shoulder strap then you will need to disconnect the shoulder strap as described on page 38.

EXTRA BASE

An Extra Base is available as a separate purchase for a second car. These bases can mean that the Carrier can be easily and quickly switched between cars. An extra top tether strap is supplied with the Base.

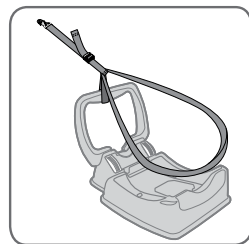

OTHER ACCESSORIES

Only use accessories designed and recommended by Britax Childcare Pty Ltd for this product.

INSTALLATION OF CAR'S UPPER ANCHORAGE POINT

Consult the vehicle owner's handbook for location of anchorage fittings or anchorage points and the possible use of spacers. Some vehicles may have an anchor fitting fitted by the vehicle manufacturer. If anchorage points cannot be found refer to car manufacturer or local child restraint fitting station or traffic authority for optimum position of upper anchorage point and the use of spacers.

UPPER ANCHORAGE STRAP



IMPORTANT:

THE ATTACHMENT CLIP COVER MUST ALWAYS BE USED AS IT PREVENTS THE RISK OF INCORRECT FITMENT OF THE ATTACHMENT CLIP TO THE UPPER ANCHORAGE POINT. ALWAYS ENSURE THAT THE ATTACHMENT CLIP IS CORRECTLY ENGAGED TO THE UPPER ANCHORAGE POINT AND NOT HOOKED OR FITTED TO ANY OTHER OBJECT BEFORE EACH USE OF THE RESTRAINT. THIS IS ESPECIALLY IMPORTANT IN VEHICLES SUCH AS STATION WAGONS, VANS, HATCH BACKS OR VEHICLES WITHOUT A FIXED PARCEL SHELF, SINCE THE ANCHOR POINT IS USUALLY NOT VISIBLE.

IMPORTANT INSTALLATION NOTE:

In some vehicles the upper anchorage point in the rear vertical panel can only be installed in one way. Please refer to vehicle owner's handbook or a child restraint fitting station for correct method.

INSTALLATION OF CAR'S UPPER ANCHORAGE POINT

Extension Strap distance to be measured.
Length 300mm (Use Safe-n-Sound part 0035 or equivalent).
Length 600mm (Use Safe-n-Sound part 0036 or equivalent).
Available from all major child restraint retailers.

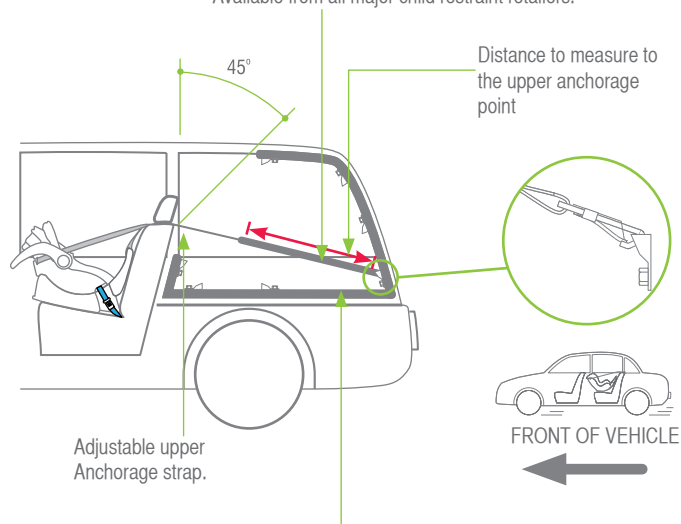

The shaded areas of this diagram illustrate the possible locations of the upper anchorage point. Within each shaded area is an upper anchorage point showing the correct way to install the fitting. Ensure the upper anchorage point is aligned as illustrated unless stated otherwise in the vehicle owner's handbook.

INSTALLATION OF CAR'S UPPER ANCHORAGE POINT

IF THE CAR IS FITTED WITH CHILD RESTRAINT UPPER ANCHORAGE POINT

Locate the upper anchorage point behind the rear seating position. (Consult the car owners handbook for the location of the upper anchorage point). The upper anchorage point should be directly behind and central to the restraint. Remove thread plug from the parcel shelf/floor/roof, etc. and install attachment bolt and fitting as shown in Fig 1.

CAUTION: DO NOT OVERTIGHTEN ATTACHMENT BOLT. OVERTIGHTENING MAY FRACTURE OR BREAK BOLT.
MAXIMUM TORQUE IS 20 Nm (14.75 ft.lb.)

Note: Minimum of five full turns of attachment bolt is required before tightening force is applied.

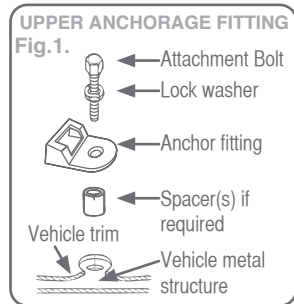

INSTALLATION OF CAR'S UPPER ANCHORAGE POINT

IF THE CAR IS NOT FITTED WITH CHILD RESTRAINT UPPER ANCHORAGE POINTS

For Sedans only - Drill 9mm diameter hole in the parcel shelf on the centre line of the seating position as shown in Fig 3. Before drilling the hole, check the underside for accessibility. Install the attachment bolt as shown in Fig 2. It is recommended that this installation be carried out by a child restraint fitting station or licenced motor mechanic.

For vehicles other than Sedans - In Australia, consult your nearest child restraint fitting station or traffic authority for vehicle inspection to find the best, correct position for the placement of the upper anchorage point, and for the correct attachment bolt length and use of spacers. In New Zealand, consult the agent for the vehicle. Note to Queensland purchasers: The installation of anchorage points must be approved by authorised officers appointed by Queensland Transport. Authorised officers can be sourced from all Queensland Transport Customer Service and Queensland Ambulance Service Centres.

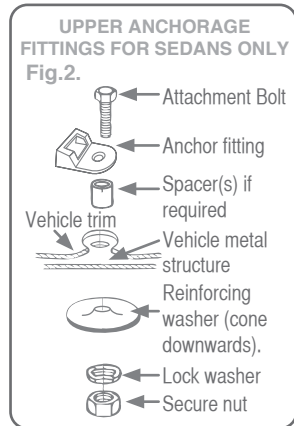

INSTALLATION OF CAR'S UPPER ANCHORAGE POINT

ONLY USE A 5/16 UNC GRADE 5 BOLT. IF THE BOLT IS NOT THE CORRECT LENGTH THE CAR MANUFACTURER'S HAND BOOK CAN PROVIDE ADVICE ON THE CORRECT LENGTH BOLT.



WARNING

CHILD RESTRAINTS MUST NOT BE ATTACHED TO UNSOUND METAL OR TO WOOD, OR SYNTHETIC STRUCTURES. WHEN DRILLING 9 MM HOLE DO NOT DRILL THROUGH FUEL LINES, FUEL TANKS, ELECTRICAL WIRING, OR RADIO SPEAKERS.

WEBBING STRAPS MUST BE PROTECTED FROM SHARP CORNERS AND EDGES. THE ANCHOR FITTING MUST BE USED ONLY AS DESCRIBED ABOVE. IT MUST NOT BE HOOKED ONTO ANY OTHER OBJECT.

CAR INSTALLATION ACCESSORIES

(From retailers of Safe-n-Sound products)

EXTRA ANCHOR KITS: Available for using the restraint in additional cars.

Re-order no: 0038

EXTENSION STRAPS: May be required for cars without a fixed parcel shelf.

Re-order no: 0035 (length 300mm) or

0036 (length 600mm)

GATED 3-BAR SLIDE (Locking clip): For converting lap-sash seat belt to lap belt, and to obtain a better fit to the car where the fitted lock-off may not be suitable. Most cars will not need this. Re-order no: 0215.

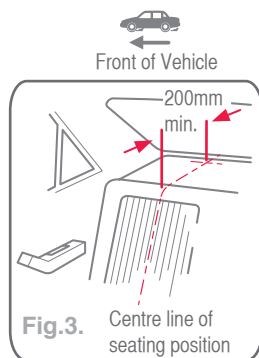
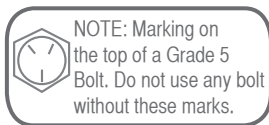

ALTERNATIVE INSTALLATION IF SEATBELT LOOSENS

LAP-SASH SEAT BELT

If a seat belt will not stay tight, then a Gated 3-Bar Slide may be used to prevent loosening. Obtain this part from most retailers of Safe-n-Sound products.

There may be two types of Gated Slides available, Curved and Flat.

Before using the restraint, convert the lap-sash seat belt by using the Gated 3-Bar Slide.

- A. Hold the lap and sash straps together and fold as shown. Slide the inner strap into the Gated 3-Bar Slide followed by the outer strap.

- B. The two straps should slide freely in the Gated 3-Bar Slide slot.

- C. Repeat previous step A for the other slot in the Gated 3-Bar Slide.

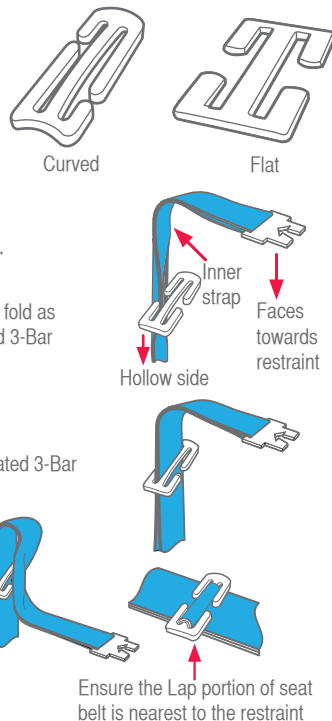

ALTERNATIVE INSTALLATION IF SEATBELT LOOSENS

D. Feed the straps through the Gated 3-Bar Slide to remove any slack.

When fitting the Curved Gated Slide, the seat belt route can only go one way, as shown above.

Use this seat belt configuration to install the child restraint according to the instructions on pages 27 to 28. Remove any slack in the lap belt to ensure the base is held firmly against the seat back. This may require adjustment of the strap through the gated 3-bar slide.

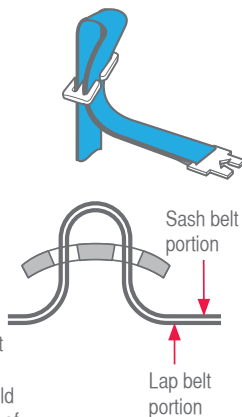

IMPORTANT:

Remove the gated 3 bar slide from the seat belt as soon as the child restraint is removed so that an adult can use the seat belt as a lap-sash seatbelt.

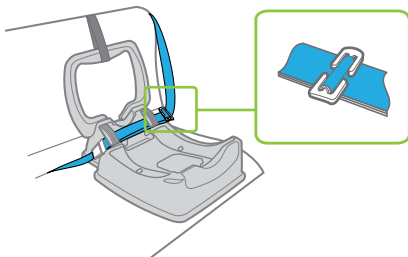

TRAVEL SYSTEM

This Infant Carrier is designed to be connected to compatible strollers. The following pages provide general instructions about using the Infant Carrier with a stroller which may differ slightly for some strollers. Preferably use the attachment instructions provided with your stroller. Use the stroller in accordance with the instructions supplied with the stroller. This Infant Carrier will not fit all strollers.

There are two methods of connecting the Infant Carrier to the stroller. Check with the stroller instructions or promotional literature to see which system applies.

- Integral latch which fits to the arm bar or tray, or
- Britax CLICK & GO™ Adaptor that fits to the receivers on the stroller side armrests.

The stroller instruction manual will provide full instructions on use of the stroller.

WARNINGS

DO NOT LEAVE THE CHILD IN THE INFANT CARRIER FOR EXTENDED PERIODS. THE TRAVEL SYSTEM INFANT CARRIER IS DESIGNED TO PROVIDE MOBILITY OUTSIDE OF THE CAR BUT IT SHOULD NOT BE USED IN PLACE OF AN APPROPRIATE COT.

THE INFANT CARRIER MUST ONLY BE USED WITH STROLLERS WITH COMPATIBLE ATTACHMENTS. WE RECOMMEND SAFE-N-SOUND AND STEELCRAFT STROLLERS.

IF IN DOUBT ABOUT THE METHOD OF INSTALLATION, CONTACT BRITAX CHILDCARE CUSTOMER SERVICE ON 1300 303 330 AU/ 0508 688 822 NZ.

TRAVEL SYSTEM INTEGRAL LATCH

INSTALLATION INSTRUCTIONS PREPARING THE INFANT CARRIER - LATCH METHOD

A. Remove baby from Infant Carrier.

You may need to remove the Britax Click & Go™ Adaptors (see page 72) to enable fitment on some strollers.

B. Rotate handle into "carry position" ① then lift the release catch with the other hand.

C. With the release catch depressed lift the Infant Carrier clear of the base hooks, and remove from the car.

D. You may need to remove the Britax Click & Go™ Adaptors (see page 72) to enable fitment on some strollers.

PREPARING THE STROLLER

A. Ensure the Stroller has been assembled correctly before fitting the Infant Carrier.

B. Open the Stroller, apply the brakes and lower the backrest to the fully reclined position.

C. Remove the arm bar cover and store in the basket pocket.

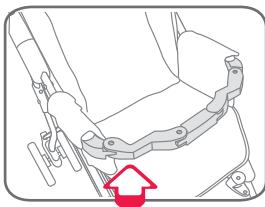

Arm Bar cover removed

* Refer to page 23 for handle position

TRAVEL SYSTEM INTEGRAL LATCH

INSTALLING THE INFANT CARRIER INTO THE STROLLER - LATCH METHOD

A. Ensure that the arm bar (or tray) is fully locked in position on both sides of the armrests.

B. Position the Infant Carrier over the Stroller with the baby's head end of the Infant Carrier over the Stroller arm bar (or tray).

C. Lower the Infant Carrier and ensure that it locates onto the Arm Bar, (or tray) and the latches engage.

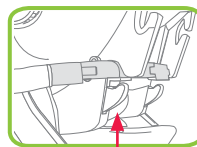
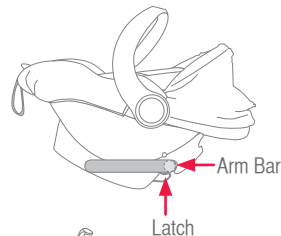

Latch

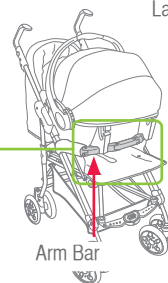

Arm Bar

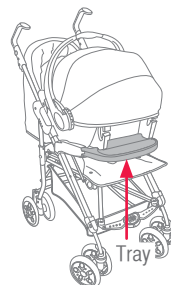

Tray

TRAVEL SYSTEM INTEGRAL LATCH

D. Then lower the foot end of the Infant Carrier until it rests on the seating surface of the stroller.

E. Rotate the Infant Carrier handle down if required, then check the Infant Carrier is securely fixed to the stroller before use.

F. Refer to the Stroller instruction book for other instructions.

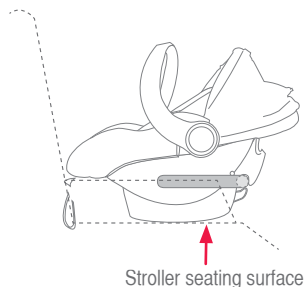

REMOVING THE INFANT CARRIER FROM THE STROLLER

A. Rotate the Infant Carrier handle up to the "carry position" as above and grip firmly in one hand.

B. Raise the Infant Carrier release catch located on the rear of the Infant Carrier.

C. Lift the Infant Carrier clear of the stroller.

ENSURE THE BABY IS SECURED IN THE INFANT CARRIER WITH THE HARNESS AT ALL TIMES. THE INFANT CARRIER IS FITTED WITH A CANOPY WHICH CAN BE USED WHEN THE CARRIER IS CONNECTED TO THE STROLLER. THE CANOPY CAN ALSO BE USED IN THE CAR.

* Refer to page 23 for handle position

TRAVEL SYSTEM BRITAX CLICK & GO™ ADAPTOR

ATTACHING THE INFANT CARRIER TO THE STROLLER FRAME

If the Infant Carrier is fitted with Britax Click & Go™ Adaptor, then fit as follows:



IMPORTANT :

Only use Infant Carrier with compatible Britax/Steelcraft Stroller. Or with other brand strollers that have an approved Britax Click & Go™ receiver.

A. Remove Stroller seat or Carry cot from frame, The Infant Carrier must face the Stroller handle. With the Infant Carrier handle in the upright position, just place the Click & Go™ adapters over the stroller frame sockets and push the Infant Carrier into the socket. The adapters will click in with an audible click.

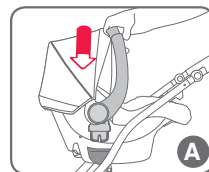

IMPORTANT :

Pull up on both sides of the Infant Carrier and confirm it is locked into the frame. If not locked on both sides, repeat above steps.

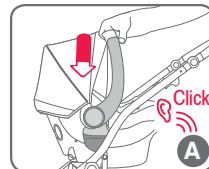

Secure your baby into the Infant Carrier with the harness provided.

TRAVEL SYSTEM BRITAX CLICK & GO™ ADAPTOR

- A. To release, use both hands to pull the left and right trigger of the Click & Go™ adaptor on your Infant Carrier upwards and de-latch the Infant Carrier away from the stroller frame.
- B. Lift and remove the Infant Carrier away from the frame.
- C. Remove the Infant Carrier before folding the stroller frame.

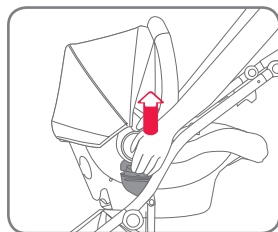
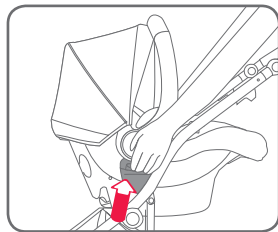
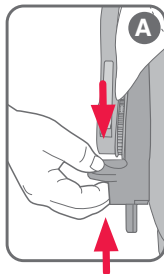

TRAVEL SYSTEM BRITAX CLICK & GO™ ADAPTOR

TO RELEASE INFANT CARRIER FROM STROLLER WITH BRITAX CLICK & GO™ ADAPTOR

- A. Squeeze both carry handle release latches and rotate the handle upwards, into the "carry position" ① to unlock the carrier from the stroller.
- B. Squeeze both left and right Britax Click & Go™ Adaptor release levers. Lift Infant Carrier upwards away from the stroller frame while squeezing levers.

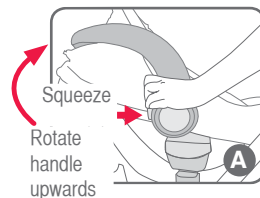

Squeeze and the lift
lever on both sides

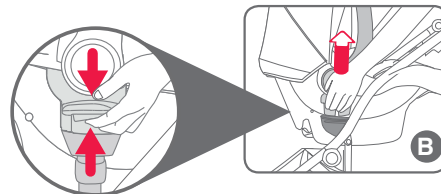

Remove the Infant Carrier before folding the stroller frame.

* Refer to page 23 for handle position

TRAVEL SYSTEM

BRITAX CLICK & GO™ ADAPTOR

HOW TO REMOVE THE BRITAX CLICK & GO™ ADAPTOR

To remove the Britax Click & Go™ Adaptor, ensure handle is in "rocking position" ②.

Cover removal is not necessary.

- A. Unclip the two infant carrier cover elastic straps which are secured by a plastic hook under the handle pivot.
- B. Gently unscrew the Press Pin and remove. Pull out the locking pin and carefully remove the adaptor from carry handle.

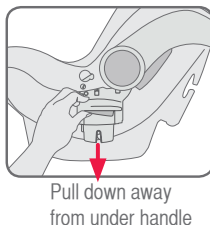
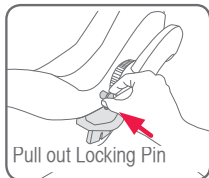
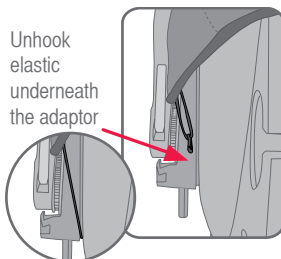

- C. Store for future use with these instructions.

TRAVEL SYSTEM

BRITAX CLICK & GO™ ADAPTOR

HOW TO REPLACE THE BRITAX CLICK & GO™ ADAPTOR

- A. To attach the Britax Click & Go™ Adaptor to the Infant Carrier ensure the Carrier's Handle is in "Rocking position" ②, disconnect the elastic under the handle boss and pull the trim away from the side of the carrier to align the holes.

- B. Align the Adaptor in the recess under the handle boss, push up and click into place.

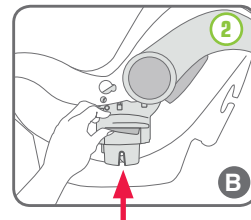

- C. Insert Locking Pin into hole. Align both top and bottom holes.

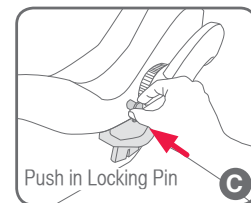

- D. Then push the Press Pin in the bottom hole and push into place.

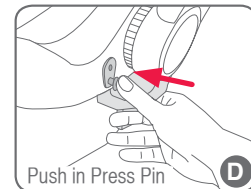

TRAVEL SYSTEM BRITAX CLICK & GO™ ADAPTOR

- E. Now replace the trim pull elastic underneath the adaptor and hook. Place elastic in groove shown below.

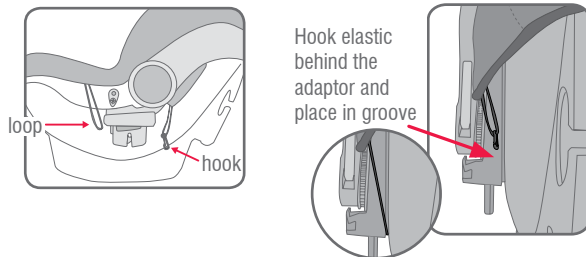

TRAVELLING TIPS

SAFETY

Never hold a baby in arms when riding in a motor vehicle. In this position the baby could be thrown against the dashboard, windscreen or other occupant and suffer serious injury or death.

When riding in a motor vehicle never nurse a baby and use the same seat belt for both of you. In this position the baby or child could be crushed.

Never breast feed a baby while car is in motion.

Children must be secured in appropriate restraints at all times when the car is in motion. Children travelling unrestrained and standing up in the car are in danger of serious injury or death. Traffic regulations in all states require children to be secured in child restraints or adult seat belts where available.

Plan your trip with frequent comfort stops to reduce stress on babies, young children and driver. Keep the car well ventilated to reduce heat stress. Car windows should be kept open to maintain a good flow of fresh air.

Never leave babies or toddlers in a stationary car because of the risk of heat exhaustion.

Ensure babies and toddlers are adequately shaded from direct sunlight through side or rear windows.

Check the car is ventilated by use opening windows or using the car's ventilation system taking in external air. Recirculation setting is not suitable for providing ventilation.

Be on guard against carbon monoxide poisoning which can occur through only a slight leak in the exhaust system while travelling in a closed car.

Securely stow all heavy objects, feeding bottles, etc. that could become missiles during an accident and cause injury to any occupant.

CLOTHING/BATHING

Since it is often warmer in the car, dress the baby in light clothing.

Do not harness an infant wrapped in a blanket or swaddled. Any blanket or wrap must only be placed over the harness and infant.

IN CASE OF CRASH

If your restraint has been involved in a severe crash, you should destroy the restraint even if no damage is obvious. Some insurance companies offer vehicle insurance which covers or partially covers the replacement of your child restraint. Contact your insurance company for further details. Your insurance company may require you to keep the child restraint for assessment, **but do not use the child restraint after a severe crash**. To assist you in making an accident insurance claim cut the following statement and include it with your claim.

NOTICE TO INSURANCE COMPANY CHILD RESTRAINT INVOLVED IN AN ACCIDENT

This Safe-n-Sound child restraint is manufactured to Australian/New Zealand Standards AS/NZS1754-2013 which requires us to advise users of child restraints to "Destroy the entire restraint if it has been in use in a severe crash, even if no damage is obvious". The joint Australian/New Zealand Standards committee CS/85, advise that this statement applies whether a child was in the child restraint or not. We consider a "severe crash" as being one where the main body structure of the vehicle is distorted.

There is no method of determining if the restraint has been damaged and we concur with the Australian/New Zealand Standards in recommending destruction of the child restraint.

This notice is to advise you of the requirements of the Australian/New Zealand Standards and our obligation in complying with the standards.

Please assist the owner of this restraint in their claim.

Britax Childcare Pty. Ltd.

(Incorporated in Victoria)
A.B.N 55 006 773 600
Head office and registered address:
99 Derby Road Sunshine Victoria 3020
PO Box 147 Sunshine Victoria 3020
Telephone: 1300 303 330

New Zealand Office
Britax Childcare NZ Limited.
Telephone: 0508 688 822

www.britax.com.au

www.britax.co.nz



IN CASE OF CRASH

CRASH EXCHANGE

We would never want you to experience an accident, but unfortunately accidents do happen.

If you experience an accident you may be eligible for a free replacement.

The Safe-n-Sound Crash Exchange Program is a voluntary program designed to ensure that our children are safe and that any seat that may have experienced a severe crash is taken out of the market.

There is no method of determining if the restraint has been damaged in a severe crash, so the restraint should be destroyed as the crash may reduce the child restraints ability to perform.

Since its inception in 2006, the Crash Exchange program has helped 100's of families ensure that their children have new restraints and that the restraints are not sold second hand placing others at risk.

Our Crash Exchange Terms and Application form are accessible on our website. Please visit www.britax.com.au for further information.



NOTES

THIS RESTRAINT IS NOT SUITABLE FOR USE WHERE THE ANCHORAGE STRAP MAY FALL INTO THE SPLIT IN THE SEAT BACK (E.G. HATCHBACK OR STATION WAGON).

The child should not sit forward facing until the child's neck muscles are able to support their head.



VERY IMPORTANT:

Only use this child restraint with the cover supplied or a manufacturer-authorised replacement cover with identical shoulder height markers.

For top tether straps:



WARNING

Straps may be damaged by unsecured cargo in a collision. Secure or remove hazardous cargo before using this strap. Hatch-back or wagon: Do not use the child restraint where the strap may fall into the seat back. Always attach and remove slack.

AUSTRALIA

Britax Childcare Pty. Ltd.
A.B.N 55 006 773 600

Head office and registered address

99 Derby Road, Sunshine, Victoria 3020.
PO Box 147 Sunshine, Victoria 3020.

Customer Service 1300 303 330

Email au-custserv@britax.com

www.britax.com.au

NEW ZEALAND

Britax Childcare (NZ) Ltd.

Customer Service 0508 688 822

Email nz-custserv@britax.com

www.britax.co.nz

INTERNATIONAL ENQUIRIES

Contact your local Distributor.

The Safe-n-Sound, Unity and ISOFLEX trademark is the property of
Britax Childcare Pty. Ltd. (Australia).

The BRITAX and Click & Go trademark are the property of Britax Childcare Holdings Ltd, UK.

We reserve the right to alter this product without notice.

© 2002-2014 Britax Childcare Pty. Ltd. Patent Pending.

Part No.2201514/B